

[www.renhal.com](http://www.renhal.com)  
[sales@renhal.com](mailto:sales@renhal.com)  
+49 8948929647





## CRAFT MANUFACTURING

### 生产车间

我们拥有先进的生产装备，运用崭新的工业概念及强大的技术力量，生产出符合国际标准的高品质产品。我们希望通过我们完善的设计、制造和售后服务确保每一台产品在有效使用期内充分发挥各项设计性能。

We have advanced production equipment, use brand-new industrial concepts and strong technical force to produce highquality products that meet international standards. We hope that through our complete design, manufacturing and aftersales service, we can ensure that each product can give full play to its design performance during the effective use period.



## FINISHED PRODUCT AREA

### 成品区

公司拥有先进的设备及检验仪器，精良的工艺以及严格完善的质量管理体系，并具有专业技术精英和领先的科技队伍，充分利用新技术、新工艺、新材料保证产品的稳定性和可靠性。

The company has advanced equipment and inspection equipment, sophisticated technology and strict and complete quality management system, and has professional and technical elites and a leading scientific and technological team, making full use of new technologies, new processes, and new materials to ensure product stability and reliability.







# APPLICATION FIELDS

## 应用领域



Petroleum  
石油



Architecture  
建筑



Biochemistry  
生化



Metallurgy  
冶金



Chemistry  
化工



Electricity  
电力



Hydraulic  
水利



Environmental  
环保

随着中国长期高速的经济增长需求，阀门行业已作为一个国民经济重要基础产业。在石油、天然气、化工、电站、冶金、国防、制药等行业与长输管线等工程发挥巨大作用。而节能降耗、资源节约是现今重工行业急需解决的重大课题。制造业也面临对原有设备进行改造与更新，淘汰耗能高、环境污染重的落后设备，阀门行业发展如何迈向一个更高的层次，节能环保和品种结构优化的日趋加大，这需要大量领先技术的阀门产品做支撑，节能减排的阀门产品更具有潜在的市场。

With China's long-term high-speed economic growth demand, the valve industry has become an important basic industry of the national economy. It plays an important role in petroleum, natural gas, chemical industry, power station, metallurgy, national defense, pharmaceutical industry and long distance pipeline projects. However, energy saving and resource saving is an urgent issue for heavy industry. Manufacturing industry is also facing to modify the original equipment and update, elimination of high energy consumption and environmental pollution of heavy equipment, how the valve industry development towards a higher level, energy conservation, environmental protection and variety structure optimization is increased, this requires a large number of leading technology products, energy conservation and emissions reduction of valve product is more potential market.



## 球阀系列

Ball valve series



国标球阀  
GB Flange ball valve



美标法兰球阀  
ANSI Flange ball valve

## 球阀系列

Ball valve series



国标法兰球阀  
GB Flange ball valve



高平台球阀  
High platform ball valve



放料球阀  
Feeding the ball valve



焊接球阀  
Welded ball valve



薄型球阀  
Thin ball valve



V型球阀  
V-shaped ball valve



涡轮浮动球阀  
Turbine floating ball valve



涡轮固定球阀  
Turbine fixed ball valve



一体式高温球阀  
One-piece high temperature ball valve



三通球阀  
The 3-way ball valve



保温球阀  
Insulation ball valve



三通保温球阀  
Tee insulation ball valve



气动三通球阀  
Pneumatic three-way ball valve



电动薄型球阀  
Electric light-weight ball valve



电动球阀  
Electric ball valve



气动球阀  
Pneumatic ball valve



闸阀系列  
Gate valve series



国标闸阀  
National standard gate valves



美标闸阀  
American standard gate valve



国标截止阀  
National standard globe valve



日标截止阀  
Japanese standard globe valve

截止阀系列  
Globe valve series



美标闸阀  
American standard gate valve



焊接闸阀  
Welding gate valves



暗杆闸阀  
Non-rising stem gate



美标截止阀  
American standard cut-off valve



波纹管截止阀  
Bellows globe valve



焊接截止阀  
Welding stop valve



保温闸阀  
Insulated gate valves



日标闸阀  
Japanese standard gate valves



气动闸阀  
Pneumatic valve



氧气截止阀  
The oxygen valve



抗生素波纹管截止阀  
Antibiotic bellows globe valve



保温截止阀  
Insulation cut-off valve



## 止回阀系列

Check valve series

## 过滤器

filter



国标旋启式止回阀  
GB Swing check valve

国标过滤器  
GB Filter



国标升降式止回阀  
GB Lift check valve



美标止回阀  
ANSI Check valve



立式止回阀  
Vertical check valve



消声止回阀  
Silencing check valve



对夹止回阀  
Wafer check valve



对夹止回阀  
Wafer check valve



焊接止回阀  
Welding check valve



焊接止回阀  
Welding check valve



美标过滤器  
ANSI Filter



篮式过滤器  
Basket strainer

## 目录

## table of Contents

阀门型号编制方法 Valve type preparation method	1-2	美标球阀 American standard ball valve	24-25
化学成分和力学性能表 Chemical composition and mechanical properties table	3	美标闸阀 American standard gate valve	26-27
国标闸阀 National standard gate valves	4-7	美标截止阀 American standard globe valve	28-29
国标球阀 National standard ball valve	8-9	美标止回阀 American standard check valve	30-31
国标截止阀 Gb globe valve	10-12	日标球阀 Japanese standard ball valve	32
固定式法兰球阀 Fixed flange ball valve	13-14	日标闸阀 Japanese standard gate valves	33
暗杆闸阀 Non-rising stem gate	15	日标截止阀 Day mark globe valve	34
国标旋启式止回阀 National standard swing check valve	16-17	法兰金属硬密封蝶阀 Flange metal hard seal butterfly valve	35-36
国标升降式止回阀 National standard lifting check valve	18-19	对夹式金属硬密封蝶阀 Clamp type metal hard seal butterfly valve	37-38
国标立式止回阀 National standard vertical check valve	20	丝扣球阀 Threaded ball valve	39
国标Y型过滤器 National standard y-type filter	21	丝扣阀门 Threaded valve	40
国标三通球阀 Gb three way ball valve	22	售后服务和质量保证承诺 After-sales service and quality assurance commitment	41-42
薄型法兰球阀 Thin flange ball valve	23		



# Establishment Method of Valve Model

## 阀门型号编制方法

阀门型号由七个单位组成按下列顺序编制  
The valve model is composed of seven units and is established according to the following sequence

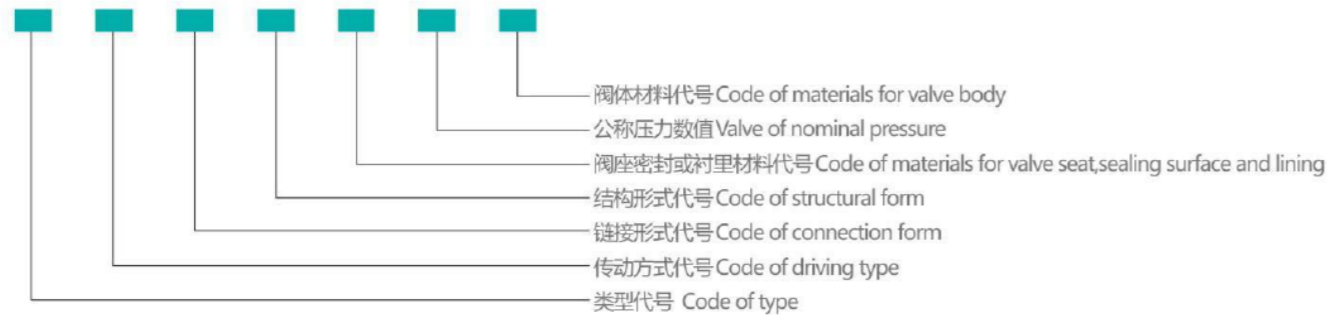

### 类型代号 Code of type

类型 Type	代号 Code	类型 Type	代号 Code	类型 Type	代号 Code
闸阀 Gate valve	Z	蝶阀 Butterfly valve	D	安全阀 Safety valve	A
截止阀 Globe valve	J	隔膜阀 Diaphragm valve	G	减压阀 Pressure reducing valve	Y
节流阀 Throttle valve	L	旋塞阀 Plug valve	X	疏水阀 Drainage valve	S
球阀 Ball valve	Q	止回阀 Check valve	H		

### 传动方式代号 code of driving type

传动方式 driving type	代号 Code	传动方式 driving type	代号 Code
电磁驱动 Electromagnetic drive	0	伞齿轮 Bevel gear	5
电磁液动 Electromagnetic and hydraulic	1	气动 Pneumatic	6
电液动 Electric and hydraulic	2	液动 Hydraulic	7
蜗轮 Worm wheel	3	气液动 Pneumatic and hydraulic	8
正齿轮 Spur gear	4	电动 Electric	9

注：(1) 手轮、手柄和扳手传动以及安全阀、减压阀、疏水阀省略本代号。

(2) 对于气动或液动：常开式用6K、7K表示；常闭式用6B、7B表示；气动带手动6S表示；防爆电动用9B。

Note: (1) For the safety valve, pressure reducing valve and drainage valve with handwheel, handle and wrench driving, the code is omitted.

(2) For pneumatic or hydraulic, the constant open type is expressed in 6K and 7K. The constant close type is expressed in 6B and 7B.

Pneumatic and manual is expressed in 6S. Electric with anti-explosion in 9B.

### 连接形式代号 code of connection form

连接形式 Connection form	内螺纹 Internal thread	外螺纹 External thread	法兰 Flange	焊接 Welding	对夹 Butt clamp	卡箍 Hoop	卡套 ferrule
代号 Code	1	2	4	6	7	8	9

### 结构形式代号 code of structural form

闸阀结构形式 Structural form of gate valve		代号 Code	
明杆 Rising stem	楔式 Wedge type	弹性闸板 Flexible gate valve	0
		单闸板 Single flashboard	1
	刚性 Rigid	双闸板 Double flashboard	2
		单闸板 Single flashboard	3
		双闸板 Double flashboard	4
		单闸板 Single flashboard	5
暗杆楔式 Non-rising stem wedge type	单闸板 Single flashboard	5	
	双闸板 Double flashboard	6	

截止阀结构形式 Structural form of globe valve 节流阀 Throttle valve	直通式 Direct through type	角式 Angle type	直流式 Direct flow type	平衡 Balance	
	代号 Code	1	4	5	直通式 Direct through type
代号 Code	1	4	5	6	7

止回阀结构形式 Structural form of check valve	直通升降式 Direct through lifting type	升降方式 Lifting vertical type	单瓣旋启式 Single-dack swing type	多瓣旋启式 Multi-dack swing type	双瓣旋启式 Double-clack swing type
代号 Code	1	2	4	5	6

# Establishment Method of Valve Model

## 阀门型号编制方法

隔膜阀结构形式 Structural form of diaphragm valve	屋脊式 Ridge type	截止式 Stopping type	直流板式 Direct flow board type	闸板式 Flashboard type
代号 Code	1	3	5	7

球阀结构形式 Structural form of ball valve	浮动球直通式 Floating direct through type	浮动球三通式 Floating ball three-junction type	固定球直通式 Fixing ball direct through type	固定球三通式 Fixing ball Three-junction type
代号 Code	1	L型 4	T型 5	7

蝶阀结构形式 Structural form butterfly valve	垂直板式 Vertical board type	斜板式 Sloping plate type	杠杆式 Lever type
代号 Code	1	3	0

减压阀结构形式 Structural form of pressure valve	薄膜式 Film type	弹簧薄膜式 Spring film type	活塞式 Piston type	波纹管事 Bellows type	杠杆式 Lever type
代号 Code	1	2	3	4	5

疏水阀结构形式 Structural form of drainage valve	浮球式 Floating ball type	钟形浮子式 Bell-shapde floater	脉冲式 Swimming Type	热动力式 Thermal power type
代号 Code	1	5	8	9

安全阀结构形式 Structural form of safety valve			代号 Code	
弹簧 Spring	密封 Closed	带散热片 With radiator	全启式 Complete starting type	0
		微启式 Micro starting type		1
		全启式 Complete starting type		2
	不密封 Non-closed	带扳手 With wrench	全启式 Complete starting type	3
			双弹簧微启式 Double-spring micro starting type	7
			微启式 micro starting type	8
		带控制机构 With control mechanism	全启式 Complete starting type	5
			微启式 micro starting type	6
			脉冲式 Swimming type	全启式 Complete starting type

注：杠杆式安全阀在类型代号前加“G”汉语拼音字母。Note: before the model code of the safety type safety valve, and the Chinese phonetic alphabet “G”.

旋塞阀结构形式 Structural form of plug valve	直通填料式 Direct through filler type	三通填料式 Three-junction filler type	直通油封式 Direct through oil seal type	三通油封式 Three-junction oil seal type
代号 Code	3	4	7	8

### 阀座密封面或衬里材料代号 Code of materials for valve seat, sealing surface and lining

阀座密封面或衬里材料 Code of materials for valve seat, sealing surface and lining	代号 Code	阀座密封面或衬里材料 Code of materials for valve seat, sealing surface and lining	代号 Code	阀座密封面或衬里材料 Code of materials for valve seat, sealing surface and lining	代号 Code
铜合金 Copper alloy	T	巴氏合金 Babbitt alloy	B	衬胶 Rubber lining	J
橡胶 Rubber	X	合金钢 Alloy steel	H	搪瓷 Porcelain enamel	C
尼龙塑料 Nylon plastic	N	渗氮钢 Nitriding steel	D	衬铅 Lead lining	Q
氟塑料 Flourine plastic	F	硬质合金 Hard alloy	Y	渗碳钢 Boron steel	P

注：由阀体直接加工的阀座密封面材料代号“W”表示；当阀座和阀瓣（闸板）密封面材料不同时，用低硬度材料代号表示（隔膜阀除外）。

Note: The code of materials for valve seat and sealing surface processed directly by the valve body is expressed in “W”. If the materials of valve seat and clack(Flashboard)sealing surface are different, it shall be expressed in the code of materials with low hardness. (Except the diaphragm valve)

### 公称压力数值 Value of nominal pressure

按JB74-59“管路附件公称压力，实验压力和工作压力”的规定；用于电站工业阀门，当介质最高温度超过530℃时，按JB74-59第5条的规定，标注工作压力。

The value of nominal pressure shall be in accordance with the stipulations in JB74-59 “Nominal pressure, testing pressure and working pressure of pipe accessories”. For the valve used in power station industry, when the maximum temperature of the medium exceeds 530℃, according to the stipulations 5 of JB74-59, note the working pressure.

### 阀体材料代号 Code of materials for valve body

阀体材料 materials for valve body	代号 Code	阀体材料 materials for valve body	代号 Code	阀体材料 materials for valve body	代号 Code
灰铸铁 Gray iron	Z	铜合金 Copper alloy	T	1Cr18Ni9Ti	P
可锻铸铁 Malleable cast iron	K	碳钢 Carbon steel	C	1Cr18Ni12Mo2Ti	R
球墨铸铁	Q	Cr5Mo	I	12CrMov	V

注：PN≤16kgf/cm<sup>2</sup>的灰铸铁阀体和PN≥25kgf/cm<sup>2</sup>的碳钢阀体，省略本单元。

Note: For the gray iron valve body with PN≤16kgf/cm<sup>2</sup> and cast iron valve body with PN≥25kgf/cm<sup>2</sup>, the unit is omitted.



# Chemical composition and mechanical properties of steel castings

## 钢制常用铸件(钢件)化学成分和力学性能

标准号 Standard number	牌号 Trademark	化学成分 Chemical composition										力学性能 Mechanical property				
		C <sub>≥</sub>	Si <sub>≥</sub>	Mn <sub>≥</sub>	P <sub>≥</sub>	S <sub>≥</sub>	Cr	Ni	Mo	V	Cu	Ob Mpa	Os Mpa	δ%	ψ%	AK/J
GB12223	WCB	0.30	0.60	1.00	0.04	0.045						485	350	22	35	
GB12229	WCC	0.25	0.60	1.2	0.04	0.045						485	275	22	35	
ZBJC8015	ZG1Cr5Mo	0.15	0.50	0.60	0.035	0.030	4.0~6.0		0.50~0.65			590	390	18	-	
ZBJC8015	ZG20CrMoV	0.18~0.24	0.17~0.37	0.4~0.70	0.030	0.030	0.9~1.2		0.50~0.70	2.00~3.0		500	320	14	30	30
ZBJC8015	ZG15Cr1Mo1V	0.14~0.20	0.17~0.30	0.4~0.70	0.030	0.030	1.20~1.7		1.00~1.2	3.00~4.0		500	350	14	30	30
GB/T5263	WC1	0.25	0.60	0.5~0.80	0.40	0.045			0.45~0.65			450	240	24	35	
GB/T5263	WC5	0.20	0.60	0.4~0.70	0.040	0.045	0.50~0.9	0.06~1.0	0.90~1.2			483	276	20	35	
GB/T5263	WC6	0.20	0.60	0.5~0.80	0.040	0.045	1.0~1.50		0.45~0.65			483	276	20	35	
GB/T5263	WC9	0.18	0.60	0.4~0.70	0.040	0.045	2.0~2.75		0.90~1.20			483	276	20	35	
GB12230 (GB2100)	ZG00Cr18Ni10	0.03	1.5	0.8~0.20	0.040	0.030	17.0~20	8.0~11.0				392	177	25	(32)	(98)
GB12230 (GB2100)	ZG0Cr18Ni9	0.08	1.5	0.8~0.20	0.040	0.030	17.0~20	8.0~11.0				441	196	25	(32)	(98)
GB12230 (GB2100)	ZG1Cr18Ni9	0.12	1.5	0.8~0.20	0.045	0.030	17.0~20	8.0~11.0				441	196	25	(32)	(98)
GB12230 (GB2100)	ZG0Cr18Ni9Ti	0.80	1.5	0.8~0.20	0.040	0.030	17.0~20	8.0~11.0	0.50~0.70			441	196	25	(32)	(98)
GB12230 (GB2100)	ZG0Cr18Ni9Ti	0.102	1.5	0.8~0.20	0.045	0.030	17.0~20	8.0~11.0	0.50~0.70			441	196	25	(32)	(98)
GB12230 (GB2100)	ZG0Cr18Ni12Ni2Ti	0.8	1.5	0.8~0.20	0.040	0.030	16.0~19	11.0~13	2.00~3.0	0.50~0.70		490	216	30	(30)	(98)
GB12230 (GB2100)	ZG1Cr18Ni12Ni2Ti	0.12	1.5	1.50	0.045	0.030	16.0~19	11.0~13	3.00~4.0	0.50~0.70		490	216	30	(30)	(98)
GB12230	CF3	0.03	2.00	1.50	0.04	0.04	17.0~21	8.0~11.0				485	206	35	-	
GB12230	CF8	0.08	2.00	1.50	0.04	0.04	18.0~21	8.0~11.0				485	206	35	-	
GB12230	CF3M	0.03	1.5	1.50	0.04	0.04	17.0~21	9.0~12.0	2.00~3.0			485	206	30	-	
GB12230	CF8M	0.08	1.50	1.50	0.04	0.04	18.0~21	9.0~12.0	3.00~4.0			485	206	30	-	
GB12230	CF8C	0.08	2.00	1.50	0.04	0.04	18.0~21	9.0~12.0		(Nb) 8xC% ~1.0		485	206	30		AKV J(mm) °C
JB/T7248	LCB	0.30	0.60	1.00	0.04	0.045						450~620	240	24	35	14/-46
JB/T7248	LC1	0.25	0.60	0.5~0.80	0.04	0.045			0.45~0.65			450~620	240	24	35	14/-59
JB/T7248	LC2	0.25	0.60	0.5~0.80	0.04	0.045			2.00~3.0			435~655	275	24	35	16/-73
JB/T7248	LC3	0.15	0.60	0.5~0.80	0.04	0.045			3.00~4.0			435~655	275	24	35	16/-101

注: 杂质(残余)元素的总和最大值的100%  
Note: 100% of total maximum value of impurity (residue) element.

# GB Gate Valve

## 国标闸阀

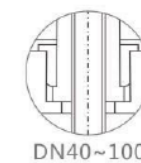
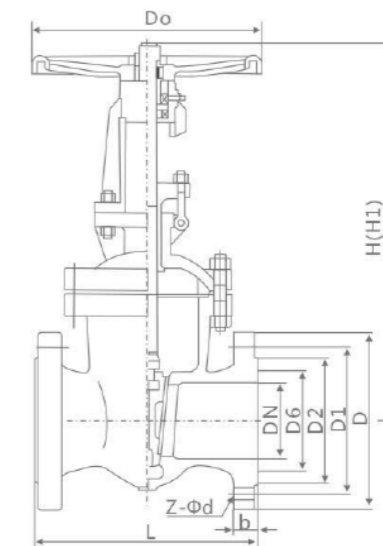

### 标准

设计与制造按GB/T12234  
结构长度按GB/T12221  
法兰连接尺寸按JB/T79  
检验按JB/T9092

### Standards

Design and manufacture as GB/T12234  
Face to face dimensions as GB/T12221  
End flange dimension as JB/T79  
Pressure test as JB/T9092

### 试验压力 Test Pressure

试验项目 Test Item	壳体试验 Shell Test	密封试验 Seal Test	上密封试验 Back Seal Test	气密封试验 Air Seal Test
介质 Medium	水 Water			气 Air
单位 Unit	MPa	MPa	MPa	MPa
公称压力 Nominal Pressure PN(MPa)	1.0	1.5	1.1	0.5~0.7
	1.6	2.4	1.8	
	2.5	3.8	2.8	
	4.0	6.0	4.4	
	6.4	9.6	7.0	
	10.0	15.0	11.0	
16.0	24.0	18.0	18.0	

### 主要零件材料 Materials for Main Parts

名称 Name	材料 Material									
阀体/阀盖 Body/Bonnet	CF8	CF3	CF8M	CF3M	WCB	LCB	WC6	WC9	C5	
闸板 Wedge	CF8	CF3	CF8M	CF3M	WCB	LCB	WC6	WC9	C5	
阀杆 Stem	F304	F304L	F316	F316L	2CR13	F304	F304	F304	F304	
阀杆螺母 Stem Nut	铝青铜 Aluminium Bronze									
填料 Packing	PTFF					石墨 Graphite				
垫片 Gasket	PTFF					石墨 Graphite				
压盖 Gland	CF8	CF3	CF8M	CF3M	WCB	LCB	WC6	WC9	C5	
螺栓 Bolt	不锈钢 Stainless Steel					35CrMoA				
螺母 Nut	不锈钢 Stainless Steel					45、35CrMoA				
手轮 Handwheel	铸钢 Cast Steel									



**GB**  
**Gate Valve**  
国标闸阀 ▶

主要连接尺寸 Main Connection Dimensions

型号 Type	公称通径 DN(mm)	尺寸 Dimensions								
		L	D	D1	D2	b-f	z-Φd	H	Do	
H Z41W-10 Y	15	130	95	65	45	12-2	4-Φ14	185	120	
	20	150	105	75	55	14-2	4-Φ14	200	120	
	25	160	115	85	65	14-2	4-Φ14	225	140	
	32	180	135	100	78	16-2	4-Φ18	275	160	
	40	165	145	110	85	16-3	4-Φ18	290	160	
	50	180	160	125	100	16-3	4-Φ18	345	200	
	65	195	180	145	120	18-3	4-Φ18	360	220	
	80	210	195	160	135	18-3	4-Φ18	380	240	
	H Z641W-10 Y	100	230	215	180	155	20-3	8-Φ18	430	280
		125	255	245	210	185	22-3	8-Φ18	520	300
150		280	280	240	210	22-3	8-Φ23	600	320	
200		330	335	295	265	22-3	8-Φ23	765	400	
250		380	390	350	320	24-3	12-Φ23	930	450	
H Z941W-10 Y	300	420	440	400	368	26-3	12-Φ23	1080	500	
	350	450	500	460	428	26-4	16-Φ23	1200	500	
	400	480	565	515	482	26-4	16-Φ35	1400	550	
	450	510	615	565	532	26-4	20-Φ25	1500	600	
	500	540	670	620	585	28-4	20-Φ25	1630	650	
	H Z41W-16 Y	15	130	95	65	45	14-2	4-Φ14	185	120
		20	150	105	75	55	14-2	4-Φ14	200	120
		25	160	115	85	65	14-2	4-Φ14	225	140
		32	180	135	100	78	16-2	4-Φ18	275	160
		40	200	145	110	85	16-3	4-Φ18	295	200
50		250	160	125	100	16-3	4-Φ18	350	220	
65		265	180	145	120	18-3	4-Φ18	370	240	
80		280	195	160	135	20-3	8-Φ18	390	280	
100		300	215	180	155	20-3	8-Φ18	435	300	
125		325	245	210	185	22-3	8-Φ18	520	320	
H Z641W-16 Y	150	350	280	240	210	24-3	8-Φ23	610	350	
	200	400	335	295	265	26-3	12-Φ23	785	400	
	250	450	405	355	320	30-3	12-Φ25	930	450	
	300	500	460	410	375	30-4	12-Φ25	1080	500	
	350	550	520	470	435	34-4	16-Φ25	1200	550	
H Z941W-16 Y	400	600	580	525	485	36-4	16-Φ30	1400	600	
	450	650	640	585	545	40-4	20-Φ30	1500	650	
	500	700	705	650	608	44-4	20-Φ34	1630	700	
	H Z41W-25 Y	15	130	95	65	45	16-2	4-Φ14	185	120
		20	150	105	75	55	16-2	4-Φ14	200	120
		25	160	115	85	65	16-2	4-Φ14	225	140
		32	180	135	100	78	18-2	4-Φ18	275	160
		40	200	145	110	85	18-3	4-Φ18	295	200
		50	250	160	125	100	20-3	4-Φ18	350	220
		65	265	180	145	120	22-3	8-Φ18	370	240
80		280	195	160	135	22-3	8-Φ18	390	280	
100		300	230	190	160	24-3	8-Φ23	435	300	
125		325	270	220	188	28-3	8-Φ25	520	320	
H Z641W-25 Y	150	350	300	250	218	30-3	8-Φ25	610	350	
	200	400	360	310	278	34-3	12-Φ25	785	400	
	250	450	425	370	332	36-3	12-Φ30	930	450	
	300	500	485	430	390	40-4	16-Φ30	1080	500	
	350	550	550	490	448	44-4	16-Φ34	1250	550	
H Z941W-25 Y	400	600	610	550	505	48-4	16-Φ34	1430	600	
	450	650	660	600	555	50-4	20-Φ34	1520	650	
	500	700	730	660	610	52-4	20-Φ41	1650	700	

**GB**  
**Gate Valve**  
国标闸阀 ▶

主要连接尺寸 Main Connection Dimensions

型号 Type	公称通径 DN(mm)	尺寸 Dimension(mm)									
		L	D	D1	D2	D6	b-f	f1	z-Φd	H	
H Z41W-40 Y	15	130	95	65	45	40	16-2	4	4-Φ14	185	
	20	150	105	75	55	51	16-2	4	4-Φ14	200	
	25	160	115	85	65	58	16-2	4	4-Φ14	225	
	32	180	135	100	78	66	18-2	4	4-Φ18	275	
	40	200	145	110	85	76	18-3	4	4-Φ18	295	
	50	250	160	125	100	88	20-3	4	4-Φ18	350	
	65	280	180	145	120	110	22-3	4	8-Φ18	370	
	80	310	195	160	135	121	22-3	4	8-Φ18	390	
	H Z641W-40 Y	100	350	230	190	160	150	24-3	4.5	8-Φ23	435
		125	400	270	220	188	176	28-3	4.5	8-Φ25	520
150		450	300	250	218	204	30-3	4.5	8-Φ25	610	
200		550	375	320	282	260	38-3	4.5	12-Φ30	970	
250		650	445	385	345	313	42-3	4.5	12-Φ34	930	
H Z941W-40 Y	300	750	510	450	408	364	46-4	4.5	16-Φ34	1080	
	350	850	570	510	465	422	52-4	5	16-Φ34	1250	
	400	950	655	585	535	474	58-4	5	16-Φ41	1430	
	450	1050	680	610	560	524	60-4	5	20-Φ41	1520	
	500	1150	755	670	612	576	62-4	5	20-Φ48	1650	

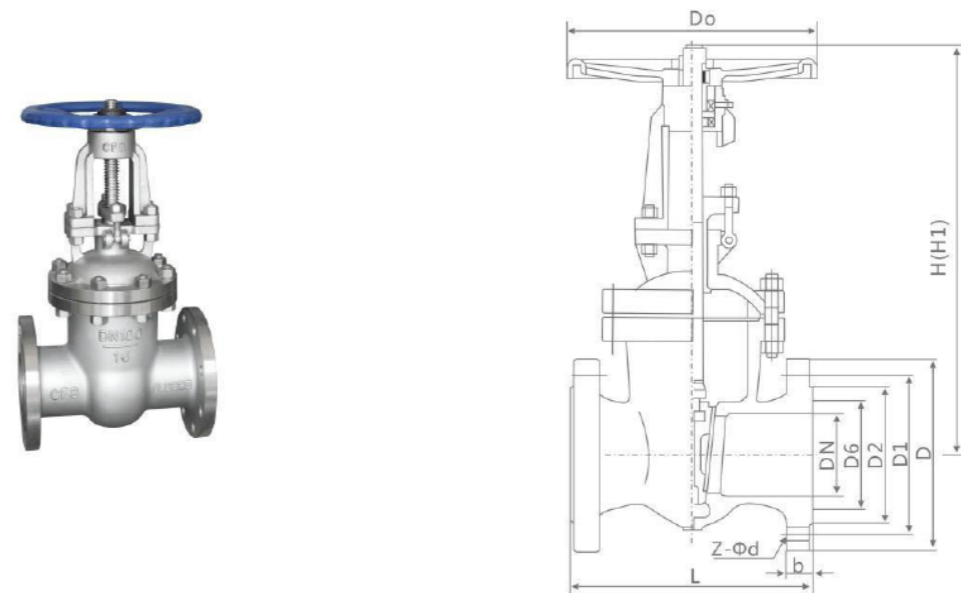



# GB Gate Valve

国标闸阀

## 主要连接尺寸 Main Connection Dimensions

型号 Type	公称通径 DN(mm)	尺寸 Dimension(mm)								
		L	D	D <sub>1</sub>	D <sub>2</sub>	D <sub>6</sub>	b-f	f <sub>1</sub>	z-Φd	H
Z41W-64 Z641W-64 Z941W-64	15	170	105	75	55	40	18-2	4	4-Φ14	185
	20	190	125	90	68	51	20-2	4	4-Φ18	200
	25	210	135	100	78	58	22-2	4	4-Φ18	225
	32	230	150	110	82	66	24-2	4	4-Φ23	280
	40	240	165	125	95	76	24-3	4	4-Φ23	300
	50	250	175	135	105	88	26-3	4	4-Φ23	360
	65	280	200	160	130	110	28-3	4	8-Φ23	385
	80	310	210	170	140	121	30-3	4	8-Φ23	400
	100	350	250	200	168	150	32-3	4.5	8-Φ25	450
	125	400	295	240	202	176	36-3	4.5	8-Φ30	540
	150	450	340	280	240	204	38-3	4.5	8-Φ34	630
	200	550	405	345	300	260	44-3	4.5	12-Φ34	820
	250	650	470	400	352	313	48-3	4.5	12-Φ41	960
	300	750	530	460	412	364	54-4	4.5	16-Φ41	1130
	350	850	595	525	475	422	60-4	5	16-Φ41	1300
400	950	670	585	525	474	66-4	5	16-Φ48	1450	
450	1050	715	630	570	524	70-4	5	20-Φ48	1550	
500	1150	800	705	640	576	70-4	5	20-Φ54	1680	
Z41W-100 Z641W-100 Z941W-100	15	170	105	75	55	40	20-2	4	4-Φ14	185
	20	190	125	90	68	51	22-2	4	4-Φ18	200
	25	210	135	100	78	58	24-2	4	4-Φ18	225
	32	230	150	110	82	66	24-2	4	4-Φ23	280
	40	240	165	125	95	76	26-3	4	4-Φ23	300
	50	250	195	145	112	88	28-3	4	4-Φ25	360
	65	280	220	170	138	110	32-3	4	8-Φ25	385
	80	310	230	180	148	121	34-3	4	8-Φ25	400
	100	350	265	210	172	150	38-3	4.5	8-Φ30	450
	125	400	310	250	210	176	42-3	4.5	8-Φ34	540
	150	450	350	290	250	204	46-3	4.5	12-Φ34	630
	200	550	430	360	312	260	54-3	4.5	12-Φ41	820
	250	650	500	430	382	313	60-3	4.5	12-Φ41	960
	300	750	585	500	442	364	70-4	4.5	16-Φ48	1130
	350	850	655	560	498	422	76-4	5	16-Φ54	1300
400	950	715	620	558	474	80-4	5	16-Φ54	1450	
450	1050	770	675	615	524	84-4	5	16-Φ58	1550	
500	1150	870	760	690	576	90-5	5	20-Φ58	1680	

# GB Ball Valve

国标球阀

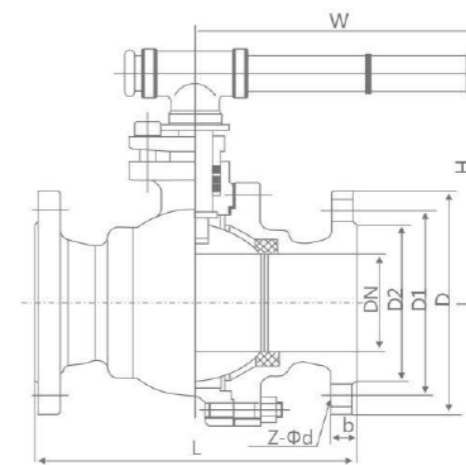

防火结构  
Fire durable

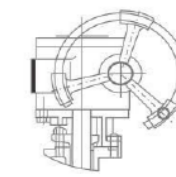

蜗轮转动  
Worm gear operation

### 标准

设计与制造按GB/T12237  
结构长度按GB/T12221  
法兰连接尺寸按JB/T79  
检验按JB/T9092

### Standards

Design and manufacture as GB/T12237  
Face to face dimensions as GB/T12221  
End flange dimension as JB/T79  
Pressure test as JB/T9092

### 试验压力 Test Pressure

试验项目 Test Item	壳体试验 Shell Test	密封试验 Seal Test	上密封试验 Back Seal Test	气密封试验 Air Seal Test
介质 Medium	水 Water			气 Air
单位 Unit	MPa	MPa	MPa	MPa
公称压力 Nominal Pressure PN(MPa)	1.6	2.4	1.8	0.5~0.7
	2.5	3.8	2.8	
	4.0	6.0	4.4	
	6.4	9.6	7.0	
	10.0	15.0	11.0	
	16.0	24.0	18.0	

### 主要零件材料 Materials for Main Parts

名称 Name	材料 Material								
阀体/阀盖 Body/Bonnet	CF8	CF3	CF8M	CF3M	WCB	LCB	WC6	WC9	C5
球体 Ball	CF8	CF3	CF8M	CF3M	WCB Hcr	CF8	CF8	CF8	CF8
阀杆 Stem	F304	F304L	F316	F316L	2CR13	F304	F304	F304	F304
阀座 Seat	PTFE/PPL								
填料/垫片 Packing/Gasket	PTFF					石墨 Graphite			
螺栓 Bolt	不锈钢 Stainless Steel					35CrMoA			
螺母 Nut	不锈钢 Stainless Steel					45、35CrMoA			
手柄 Handle	铸钢 Cast Steel								



# GB Ball Valve 国标球阀

## 主要连接尺寸 Main Connection Dimensions

型号 Type	公称通径 DN(mm)	尺寸 Dimension(mm)									
		L	D	D1	D2	D6	b-f	z-Φd	H	W	
Q41Y-16 F H	15	130	95	65	45		14-2	4-Φ14	65	115	
	20	140	105	75	55		14-2	4-Φ14	75	130	
	25	150	115	85	65		14-2	4-Φ14	85	150	
	32	165	135	100	78		16-2	4-Φ18	95	190	
	40	180	145	110	85		16-3	4-Φ18	105	230	
	50	200	160	125	100		16-3	4-Φ18	115	240	
	Q341Y-16 F H	65	220	180	145	120		18-3	4-Φ18	145	280
		80	250	195	160	135		20-3	8-Φ18	160	310
		100	280	215	180	155		20-3	8-Φ18	185	330
Q641Y-16 F H	125	320	245	210	185		22-3	8-Φ18	215	600	
	150	360	280	240	210		24-3	8-Φ23	245	800	
	200	400	335	295	265		26-3	12-Φ23	300	1000	
	250	450	405	355	320		30-3	12-Φ25	380	1200	
	15	130	95	65	45		14-2	4-Φ14	65	115	
	20	140	105	75	55		14-2	4-Φ14	75	130	
	25	150	115	85	65		14-2	4-Φ14	85	150	
	32	165	135	100	78		16-2	4-Φ18	95	190	
	40	180	145	110	85		18-3	4-Φ18	105	230	
Q41Y-25 F H	50	200	160	125	100		20-3	4-Φ18	115	240	
	65	220	180	145	120		22-3	8-Φ18	145	280	
	80	250	195	160	135		22-3	8-Φ18	160	310	
Q341Y-25 F H	100	280	230	190	160		24-3	8-Φ23	185	330	
	125	320	270	220	188		28-3	8-Φ25	215	600	
	150	360	300	250	218		30-3	8-Φ25	245	800	
Q641Y-25 F H	200	400	360	310	278		34-3	12-Φ25	300	1000	
	250	450	425	370	332		36-3	12-Φ30	380	1200	
	15	130	95	65	45	40	16-2	4-Φ14	70	115	
20	140	105	75	55	51	16-2	4-Φ14	80	130		
25	150	115	85	65	58	16-2	4-Φ14	90	150		
32	180	135	100	78	66	18-3	4-Φ18	100	190		
40	200	145	110	85	76	18-3	4-Φ18	110	230		
Q41Y-40 F H	50	220	160	125	100	88	20-3	4-Φ18	120	240	
	65	250	180	145	120	110	22-3	8-Φ18	150	280	
	80	280	195	160	135	121	22-3	8-Φ18	170	310	
Q341Y-40 F H	100	320	230	190	160	150	24-3	8-Φ23	190	330	
	125	360	270	220	188	176	28-3	8-Φ25	220	600	
	150	400	300	250	218	204	30-3	8-Φ25	250	800	
Q641Y-40 F H	200	550	375	320	282	260	38-3	12-Φ30	390	1200	
	15	140	105	75	55	40	18-2	4-Φ14	75	115	
	20	160	125	90	68	51	20-2	4-Φ18	85	130	
25	180	135	100	78	58	22-2	4-Φ18	95	150		
32	200	150	110	82	66	24-2	4-Φ23	105	190		
40	220	165	125	95	76	24-3	4-Φ23	120	230		
Q41Y-64 F H	50	250	175	135	105	88	26-3	4-Φ23	130	240	
	65	280	200	160	130	110	28-3	8-Φ23	160	280	
	80	320	210	170	140	121	30-3	8-Φ23	180	310	
Q341Y-64 F H	100	360	250	200	168	150	32-3	8-Φ25	200	330	
	125	381	295	240	202	176	36-3	8-Φ30	230	600	
	150	403	340	280	240	204	38-3	8-Φ34	260	800	
Q641Y-64 F H	200	502	405	345	300	260	44-3	12-Φ34	400	1200	

# GB Globe Valve 国标截止阀

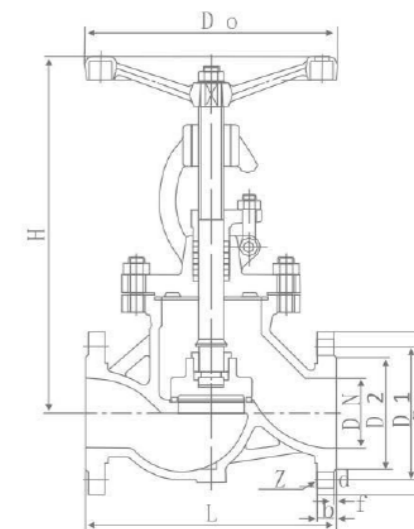

**标准**  
设计与制造按GB/T12235  
结构长度按GB/T12221  
法兰连接尺寸按JB/T79  
检验按JB/T9092

**Standards**  
Design and manufacture as GB/T12235  
Face to face dimensions as GB/T12221  
End flange dimension as JB/T79  
Pressure test as JB/T9092

## 试验压力 Test Pressure

试验项目 Test Item	壳体试验 Shell Test	密封试验 Seal Test	上密封试验 Back Seal Test	气密封试验 Air Seal Test
介质 Medium	水 Water			气 Air
单位 Unit	MPa	MPa	MPa	MPa
公称压力 Nominal Pressure PN(MPa)	1.6	2.4	1.8	0.5~0.7
	2.5	3.8	2.8	
	4.0	6.0	4.4	
	6.4	9.6	7.0	
	10.0	15.0	11.0	
	16.0	24.0	18.0	

## 主要零件材料 Materials for Main Parts

名称 Name	材料 Material								
阀体/阀盖 Body/Bonnet	CF8	CF3	CF8M	CF3M	WCB	LCB	WC6	WC9	C5
阀瓣 Wedge	CF8	CF3	CF8M	CF3M	WCB	LCB	WC6	WC9	C5
阀杆 Stem	F304	F304L	F316	F316L	2CR13	F304	F304	F304	F304
阀杆螺母 Stem Nut	铝青铜 Aluminium Bronze								
填料 Packing	PTFF				石墨 Graphite				
垫片 Gasket	PTFF				石墨 Graphite				
压盖 Gland	CF8	CF3	CF8M	CF3M	WCB	LCB	WC6	WC9	C5
螺栓 Bolt	不锈钢 Stainless Steel				35CrMoA				
螺母 Nut	不锈钢 Stainless Steel				45、35CrMoA				
手轮 Handwheel	铸钢 Cast Steel								



**GB**  
**Globe Valve**  
国标截止阀 ▶

主要连接尺寸 Main Connection Dimensions

型号 Type	公称通径 DN(mm)	尺寸 Dimension(mm)								
		L	D	D1	D2	b-f	z-Φd	H	Do	
J41W-16 H Y	15	130	95	65	45	14-2	4-Φ14	190	100	
	20	150	105	75	55	14-2	4-Φ14	200	120	
	25	160	115	85	65	14-2	4-Φ14	225	140	
	32	180	135	100	78	16-2	4-Φ18	235	160	
	40	200	145	110	85	16-3	4-Φ18	265	200	
	50	230	160	125	100	16-3	4-Φ18	280	220	
	65	290	180	145	120	18-3	4-Φ18	350	240	
	80	310	195	160	135	20-3	8-Φ18	360	280	
	J641W-16 H Y	100	350	215	180	155	20-3	8-Φ18	410	320
		125	400	245	210	185	22-3	8-Φ18	450	350
	J941W-16 H Y	150	480	280	240	210	24-3	8-Φ23	480	400
		200	600	335	295	265	26-3	12-Φ23	600	450
		250	650	405	355	320	30-3	12-Φ25	720	550
		300	750	460	410	375	30-3	12-Φ25	950	650
		350	850	520	470	435	34-4	16-Φ25	1040	750
400		950	580	525	485	36-4	16-Φ30	1150	800	
450		1050	640	585	545	40-4	20-Φ30	1250	850	
500		1150	705	650	608	44-4	20-Φ34	1380	950	
J41W-25 H Y	15	130	95	65	45	16-2	4-Φ14	190	100	
	20	150	105	75	55	16-2	4-Φ14	200	120	
	25	160	115	85	65	16-2	4-Φ14	225	140	
	32	180	135	100	78	18-2	4-Φ18	235	160	
	40	200	145	110	85	18-3	4-Φ18	265	200	
	50	230	160	125	100	20-3	4-Φ18	280	220	
	65	290	180	145	120	22-3	8-Φ18	350	240	
	80	310	195	160	135	22-3	8-Φ18	360	280	
	J641W-25 H Y	100	350	230	190	160	24-3	8-Φ23	410	320
		125	400	270	220	188	28-3	8-Φ25	450	350
	J941W-25 H Y	150	480	300	250	218	30-3	8-Φ25	480	400
		200	600	360	310	278	34-3	12-Φ25	600	450
		250	650	425	370	335	36-3	12-Φ30	720	550
		300	750	485	430	390	40-4	16-Φ30	950	650
		350	850	550	490	448	44-4	16-Φ34	1040	750
400		950	610	550	505	48-4	16-Φ34	1150	800	
450		1050	660	600	555	50-4	20-Φ34	1250	850	
500		1150	730	660	610	52-4	20-Φ41	1380	950	

**GB**  
**Globe Valve**  
国标截止阀 ▶

主要连接尺寸 Main Connection Dimensions

型号 Type	公称通径 DN(mm)	尺寸 Dimension(mm)										
		L	D	D1	D2	D6	b-f	f1	z-Φd	H	Do	
J41W-40 H Y	15	130	95	65	45	40	16-2	4	4-Φ14	190	100	
	20	150	105	75	55	51	16-2	4	4-Φ14	200	120	
	25	160	115	85	65	58	16-2	4	4-Φ14	225	140	
	32	180	135	100	78	66	18-2	4	4-Φ18	235	160	
	40	200	145	110	85	76	18-3	4	4-Φ18	265	200	
	50	230	160	125	100	88	20-3	4	4-Φ18	280	220	
	65	290	180	145	120	110	22-3	4	8-Φ18	350	240	
	J641W-40 H Y	80	310	195	160	135	121	22-3	4	8-Φ18	360	280
		100	350	230	190	160	150	24-3	4.5	8-Φ23	410	320
	J941W-40 H Y	125	400	270	220	188	176	28-3	4.5	8-Φ25	450	350
		150	480	300	250	218	204	30-3	4.5	8-Φ25	480	400
		200	600	375	320	282	260	38-3	4.5	12-Φ30	600	450
		250	650	445	385	345	313	42-3	4.5	12-Φ34	720	550
		300	750	510	450	408	364	46-4	4.5	16-Φ34	950	650
		350	850	570	510	465	422	52-4	5	16-Φ34	1050	750
400		950	655	585	535	474	58-4	5	16-Φ41	1170	800	
450		1050	680	610	560	524	60-4	5	20-Φ41	1400	850	
J41W-64 H Y	15	170	105	75	55	40	18-2	4	4-Φ14	200	120	
	20	190	125	90	68	51	20-2	4	4-Φ18	210	140	
	25	210	135	100	78	58	22-2	4	4-Φ18	235	160	
	32	230	150	110	82	66	24-2	4	4-Φ23	265	200	
	40	260	165	125	95	76	24-3	4	4-Φ23	330	220	
	J641W-64 H Y	50	300	175	135	105	88	26-3	4	4-Φ23	360	240
		65	340	200	160	130	110	28-3	4	8-Φ23	400	280
	J941W-64 H Y	80	380	210	170	140	121	30-3	4	8-Φ23	480	320
		100	430	250	200	168	150	32-3	4.5	8-Φ25	530	350
		125	500	295	240	202	176	36-3	4.5	8-Φ30	600	400
		150	550	340	280	240	204	38-3	4.5	8-Φ34	680	450
		200	650	405	345	300	260	44-3	4.5	12-Φ34	750	550



# Fixed flange ball valve

## 固定式法兰球阀

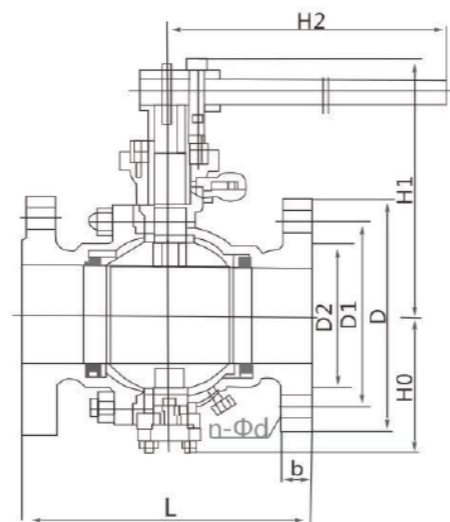

由于长输管线用阀的独有特征，因而在设计时充分考虑了其承受管道应力的能力，以及安全性，耐候性，长期使用的可靠性等；本阀整部及零件都为铸件。法兰球阀主要用于化工、冶金、石油、制药等行业的各种高压介质输送管道中。

法兰球阀设计主要的特点有：全径/缩径；90度定位和带锁结构；特殊形式的“Y”头手柄；防火和防静电设计；一对相向的蝶形弹簧；防吹出阀杆；阀杆中部双重密封结构；螺栓、螺纹垫片密封阀盖。

使用温度：-196~450℃；  
驱动方式：手动、气动、电动、液动；  
公称通径：1/2"~12"；  
公称压力：150LB~1500LB；  
使用介质：水、气、油品、天然气和酸碱腐蚀介质。

法兰球阀产品采用标准：  
1、实际、制造按API6D；  
2、结构长度按ANSI B16.10；  
3、连接法兰：ANSI B16.5MSS-SP44；  
4、阀门检查和试验按API STD.598；  
5、承插端符合ASME B16.11；  
6、螺纹连接端（NPT）符合ANSI/ASME B1.20.1

### 性能参数 The performance parameters

试验压力(MPa)	公称压力(MPa)						压力级(Class)						
	1.6	2.5	4.0	6.4	10.0	16.0	25.0	150	300	400	600	900	1500
强度试验	2.4	3.8	6.0	9.6	15.0	24	37.5	3.1	7.8	15.3	15.3	23.1	38.4
密封试验	1.8	2.8	4.4	7.0	11.0	17.6	27.5	2.2	5.6	11.2	11.2	16.8	28.1
气密试验	0.5-0.7												
工作温度	PIEE≤150℃≤300℃碳纤≤350℃												
适用介质	C：水、油、蒸汽 P：硝酸类（温度≤200℃） R：醋酸类（温度≤200℃）												

### 主要零件材料 Main parts and materials

零件名称	材料			
	C	L	P	R
阀体 阀盖	WCB	ZG00Cr17Ni14Mo2(CF3M)	ZG1Cr18 Ni9Ti(CF8)	ZG1Cr18 Ni12Mo2Ti(CF8M)
球体	2Cr13	ZG00Cr17Ni14Mo2(CF3M)	ZG1Cr18 Ni9Ti(CF8)	ZG1Cr18 Ni12Mo2Ti(CF8M)
阀杆	2Cr13	316L	1Cr18 Ni9Ti(304)	1Cr18 Ni12Mo2Ti(316)
阀座密封面	PIEE、碳纤维+PTFE、对位聚苯			
螺栓 螺母	35 35CrMoA(B7)45(2H) 2Cr13(420)1Cr18 Ni9 1Cr17Ni2(431)			
填料	V型PTFE、柔性石墨			

# Fixed flange ball valve

## 固定式法兰球阀

### 主要外形和连接尺寸 Main dimensions and connection dimensions

单位：mm

1.6MPa	DN	L	D	D1	D2	b	n-Φb	H0	H1	H2
凸面法兰 Q347F 16C 16P 16R	32	140	135	100	78	16	4-18	30	85	160
	40	165	145	110	85	16	4-18	32	95	230
	50	178	160	125	100	16	4-18	43	107	230
	65	190	180	145	120	18	4-18	70	142	400
	80	203	195	160	135	20	8-18	110	152	400
	100	305	215	180	155	20	8-18	150	178	500
	125	356	245	210	185	22	8-18	200	252	500
	150	394	280	240	210	24	8-23	230	278	600
	200	457	335	295	265	26	12-23	260	395	600
	250	533	405	355	320	30	12-25	283	480	800
	300	610	460	410	375	30	12-25	380	585	800
	350	686	520	470	435	34	16-25	425	625	800
	400	762	580	525	454	36	16-30	492	720	800
	500	914	705	650	608	44	20-34	555	840	830
600	1067	840	770	718	48	20-41	675	1050	830	
700	1245	910	940	788	50	24-41	850	1150	830	

2.5MPa	DN	L	D	D1	D2	b	n-Φb	H0	H1	H2
凸面法兰 Q347F 25 25P 25R	32	180	135	100	78	18	4-18	30	85	160
	40	190	145	110	85	18	4-18	32	95	230
	50	216	160	125	100	20	4-18	43	107	230
	65	241	180	145	120	22	8-18	70	142	400
	80	283	195	160	135	22	8-18	110	152	400
	100	305	230	190	160	24	8-23	150	178	500
	125	381	270	220	188	28	8-25	200	252	500
	150	403	300	250	218	30	12-25	230	278	600
	200	502	360	310	278	34	12-30	260	395	600
	250	568	425	370	332	36	16-30	283	480	800
	300	648	485	430	390	40	16-34	380	585	800
	350	762	550	490	448	44	16-34	425	625	800
	400	838	610	550	505	48	16-34	492	720	800
	500	991	730	660	610	52	20-41	555	840	830
600	1143	840	770	718	56	20-41	675	1050	830	
700	1346	955	875	815	60	24-48	850	1150	830	

4.0MPa	DN	L	D	D1	D2	D2	b	n-Φb	H0	H1	H2
凸面法兰 Q347F 40 40P 40R	32	180	135	100	78	66	18	4-18	30	85	160
	40	190	145	110	85	76	18	4-18	32	95	230
	50	216	160	125	100	88	20	4-18	43	107	230
	65	241	180	145	120	110	22	8-18	70	142	400
	80	283	195	160	135	121	22	8-18	110	152	400
	100	305	230	190	160	150	24	8-23	150	178	500
	125	381	270	220	188	176	28	8-25	200	252	500
	150	403	300	250	218	204	30	8-25	230	278	600
	200	502	375	320	282	260	38	12-30	260	395	600
	250	568	445	385	345	313	42	12-34	283	480	800
	300	648	510	450	408	364	46	16-34	380	585	800
	350	762	570	510	465	422	52	16-34	425	625	800
	400	838	655	585	535	472	58	16-41	492	720	800
	500	991	755	670	612	576	62	20-48	555	840	830
600	1143	890	795	730	678	62	20-54	675	1050	830	
700	1346	995	900	835	768	68	24-54	850	1150	830	



# Dark Bar Valve

## 暗杆闸阀

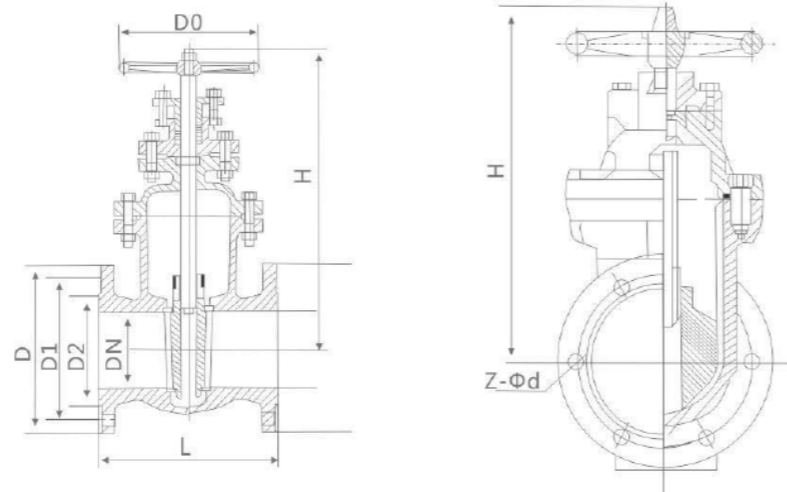

### 主要零部件材料 Main component materials

名称	材料
阀体	不锈钢、灰铸铁、铸钢
闸板	不锈钢外覆三元乙丙或丁腈橡胶
内六角螺栓	碳化处理
密封圈	丁腈橡胶
阀盖	不锈钢、灰铸铁、铸钢
阀杆	不锈钢
"O"形密封圈	丁腈橡胶
止推轴承	锡青铜
螺栓	不锈钢
压盖	不锈钢、铸钢
防尘罩	丁腈橡胶
手轮(传动帽)	铸铁

### 主要技术参数 Main technical parameters

公称压力	1.0 ~ 2.5MPa
工作温度	0 ~ 80°C
法兰标准	GB/T 17241.6 Gb9113
公称通径	50 ~ 600mm
适用介质	水、油、气等
试验标准	GB13927 Ap1598

### 主要连接尺寸 Main Connection Dimensions

公称通径 DN(mm)	尺寸 Dimensions							
	L	D	D1	D2	b-f	z-Φd	H	Do
50	180	160	125	100	16-3	4-Φ18	355	200
65	195	180	145	120	18-3	4-Φ18	375	220
80	210	195	160	135	18-3	4-Φ18	415	240
100	230	215	180	155	20-3	8-Φ18	476	280
125	255	245	210	185	22-3	8-Φ18	540	300
150	280	280	240	210	22-3	8-Φ23	600	320
200	330	335	295	265	22-3	8-Φ23	720	400
250	380	390	350	320	24-3	12-Φ23	875	450
300	420	440	400	368	26-3	12-Φ23	990	500
350	450	500	460	428	26-4	16-Φ23	1050	500
400	480	565	515	482	26-4	16-Φ35	1245	550
450	510	615	565	532	26-4	20-Φ25	1310	600
500	540	670	620	585	28-4	20-Φ25	1560	650

# GB Swing Check Valve

## 国标旋启式止回阀

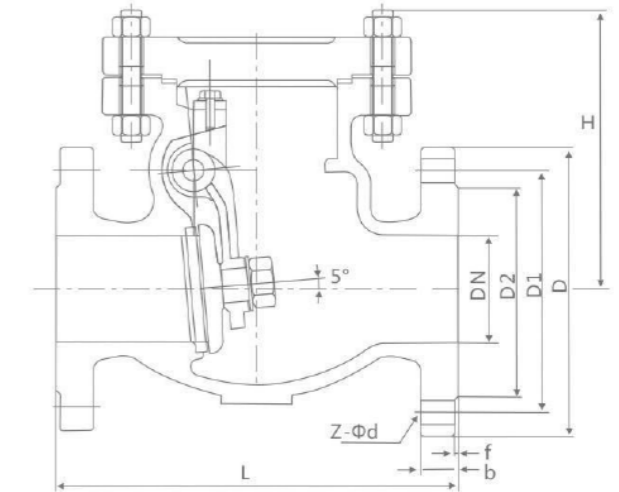

### 标准

设计与制造按GB/T12236  
结构长度按GB/T12221  
法兰连接尺寸按JB/T79  
检验按JB/T9092

### Standards

Design and manufacture as GB/T12236  
Face to face dimensions as GB/T12221  
End flange dimension as JB/T79  
Pressure test as JB/T9092

### 试验压力 Test Pressure

试验项目 Test Item	壳体试验 Shell Test	密封试验 Seal Test	上密封试验 Back Seal Test	气密封试验 Air Seal Test
介质 Medium	水 Water			气 Air
单位 Unit	MPa	MPa	MPa	MPa
公称压力 Nominal Pressure PN(MPa)	1.6	2.4	1.8	0.5~0.7
	2.5	3.8	2.8	
	4.0	6.0	4.4	
	6.4	9.6	7.0	
	10.0	15.0	11.0	
	16.0	24.0	18.0	

### 主要零件材料 Materials for Main Parts

名称 Name	材料 Material								
阀体/阀盖 Body/Bonnet	CF8	CF3	CF8M	CF3M	WCB	LCB	WC6	WC9	C5
阀瓣 Wedge	CF8	CF3	CF8M	CF3M	WCB	LCB	WC6	WC9	C5
垫片 Gasket	PTFF				石墨 Graphite				
螺栓 Bolt	不锈钢 Stainless Steel				35CrMoA				
螺母 Nut	不锈钢 Stainless Steel				45、35CrMoA				



# GB Swing Check Valve

国标旋启式止回阀 ▶

主要连接尺寸 Main Connection Dimensions

型号 Type	公称通径 DN(mm)	尺寸 Dimension(mm)							
		L	D	D1	D2	D6	b-f	z-Φd	H
H44W-16	20	150	105	75	55		14-2	4-Φ14	100
	25	160	115	85	65		14-2	4-Φ14	100
	32	180	135	100	78		16-2	4-Φ18	105
	40	200	145	110	85		16-3	4-Φ18	115
	50	230	160	125	100		16-3	4-Φ18	135
	65	290	180	145	120		18-3	4-Φ18	140
	80	310	195	160	135		20-3	8-Φ18	145
	100	350	215	180	155		20-3	8-Φ18	165
	125	400	245	210	185		22-3	8-Φ18	250
	150	480	280	240	210		24-3	8-Φ23	295
	200	550	335	295	265		26-3	12-Φ23	315
	250	650	405	355	320		30-3	12-Φ25	430
	300	750	460	410	375		30-4	12-Φ25	480
	350	850	520	470	435		34-4	16-Φ25	500
	400	950	580	525	485		36-4	16-Φ30	520
	450	1050	640	585	545		40-4	20-Φ30	580
500	1150	705	650	608		44-4	20-Φ34	630	
600	1350	840	770	718		48-5	20-Φ41	780	
H44W-25	20	150	105	75	55		16-2	4-Φ14	100
	25	160	115	85	65		16-2	4-Φ14	100
	32	180	135	100	78		18-2	4-Φ18	105
	40	200	145	110	85		18-3	4-Φ18	115
	50	230	160	125	100		20-3	4-Φ18	135
	65	290	180	145	120		22-3	8-Φ18	140
	80	310	195	160	135		22-3	8-Φ18	145
	100	350	230	190	160		24-3	8-Φ23	165
	125	400	270	220	188		28-3	8-Φ25	250
	150	480	300	250	218		30-3	8-Φ25	295
	200	550	360	310	278		34-3	12-Φ25	315
	250	650	425	370	332		36-3	12-Φ30	430
	300	750	485	430	390		40-4	16-Φ30	480
	350	850	550	490	448		44-4	16-Φ34	500
	400	950	610	550	505		48-4	16-Φ34	520
	450	1050	660	600	555		50-4	20-Φ34	580
500	1150	730	660	610		52-4	20-Φ41	630	
600	1350	840	770	718		56-5	20-Φ41	780	
H44W-40	20	150	105	75	55	51	16-2	4-Φ14	100
	25	160	115	85	65	58	16-2	4-Φ14	100
	32	180	135	100	78	66	18-2	4-Φ18	105
	40	200	145	110	85	76	18-3	4-Φ18	115
	50	230	160	125	100	88	20-3	4-Φ18	135
	65	290	180	145	120	110	22-3	8-Φ18	140
	80	310	195	160	135	121	22-3	8-Φ18	145
	100	350	230	190	160	150	24-3	8-Φ23	165
	125	400	270	220	188	176	28-3	8-Φ25	250
	150	480	300	250	218	204	30-3	8-Φ25	295
	200	550	375	320	282	260	38-3	12-Φ30	315
	250	650	445	385	345	313	42-3	12-Φ34	430
	300	750	510	450	408	364	46-4	16-Φ34	480
	350	850	570	510	465	422	52-4	16-Φ34	500
	400	950	655	585	535	474	58-4	16-Φ41	520
	450	1050	680	610	560	524	60-4	20-Φ41	580
500	1150	755	670	612	576	62-4	20-Φ48	630	
600	1350	890	795	730	678	62-5	20-Φ54	780	

# GB Piston-lift Type Check Valve

国标升降式止回阀 ▶

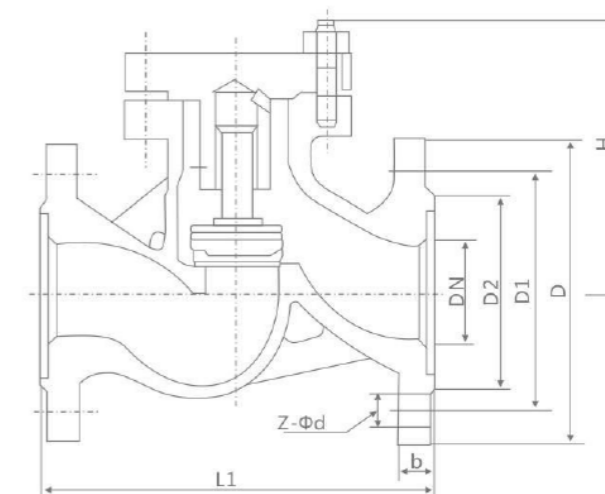

**标准**

设计与制造按GB/T12235  
 结构长度按GB/T12221  
 法兰连接尺寸按JB/T79  
 检验按JB/T9092

**Standards**

Design and manufacture as GB/T12235  
 Face to face dimensions as GB/T12221  
 End flange dimension as JB/T79  
 Pressure test as JB/T9092

**试验压力 Test Pressure**

试验项目 Test Item	壳体试验 Shell Test	密封试验 Seal Test	上密封试验 Back Seal Test	气密封试验 Air Seal Test
介质 Medium	水 Water			气 Air
单位 Unit	MPa	MPa	MPa	MPa
公称压力 Nominal Pressure PN(MPa)	1.6	2.4	1.8	0.5~0.7
	2.5	3.8	2.8	
	4.0	6.0	4.4	
	6.4	9.6	7.0	
	10.0	15.0	11.0	
	16.0	24.0	18.0	

**主要零件材料 Materials for Main Parts**

名称 Name	材料 Material									
阀体/阀盖 Body/Bonnet	CF8	CF3	CF8M	CF3M	WCB	LCB	WC6	WC9	C5	
阀瓣 Wedge	CF8	CF3	CF8M	CF3M	WCB	LCB	WC6	WC9	C5	
垫片 Gasket	PTFF					石墨 Graphite				
螺栓 Bolt	不锈钢 Stainless Steel					35CrMoA				
螺母 Nut	不锈钢 Stainless Steel					45、35CrMoA				

# GB Piston-lift Type Check Valve

国标升降式止回阀 ▶

主要连接尺寸 Main Connection Dimensions

型号 Type	公称通径 DN(mm)	尺寸 Dimension(mm)								
		L	D	D1	D2	D6	b-f	f1	z-Φd	H
H H41W-16 Y	15	130	95	65		45	14-2		4-Φ14	90
	20	150	105	75		55	14-2		4-Φ14	105
	25	160	115	85		65	14-2		4-Φ14	115
	32	180	135	100		78	16-2		4-Φ18	120
	40	200	145	110		85	16-3		4-Φ18	130
	50	230	160	125		100	16-3		4-Φ18	140
	65	290	180	145		120	18-3		4-Φ18	150
	80	310	195	160		135	20-3		8-Φ18	170
	100	350	215	180		155	20-3		8-Φ18	185
	125	400	245	210		185	22-3		8-Φ18	195
	150	480	280	240		210	24-3		8-Φ23	225
	200	600	335	295		265	26-3		12-Φ23	250
250	650	405	355		320	30-3		12-Φ25	270	
300	750	460	410		375	30-3		12-Φ25	300	
H H41W-25 Y	15	130	95	65		45	16-2		4-Φ14	90
	20	150	105	75		55	16-2		4-Φ14	105
	25	160	115	85		65	16-2		4-Φ14	115
	32	180	135	100		78	18-2		4-Φ18	120
	40	200	145	110		85	18-3		4-Φ18	130
	50	230	160	125		100	20-3		4-Φ18	140
	65	290	180	145		120	22-3		8-Φ18	150
	80	310	195	160		135	22-3		8-Φ18	170
	100	350	230	190		160	24-3		8-Φ23	185
	125	400	270	220		188	28-3		8-Φ25	195
	150	480	300	250		218	30-3		8-Φ25	225
	200	600	360	310		278	34-3		12-Φ25	250
250	650	425	370		335	36-3		12-Φ30	270	
300	750	485	430		390	40-4		16-Φ30	300	
H H41W-40 Y	25	160	115	85	65	58	16-2	4	4-Φ14	115
	32	180	135	100	78	66	18-2	4	4-Φ18	120
	40	200	145	110	85	76	18-3	4	4-Φ18	130
	50	230	160	125	100	88	20-3	4	4-Φ18	140
	65	290	180	145	120	110	22-3	4	8-Φ18	150
	80	310	195	160	135	121	22-3	4	8-Φ18	170
	100	350	230	190	160	150	24-3	4.5	8-Φ23	185
	125	400	270	220	188	176	28-3	4.5	8-Φ25	195
	150	480	300	250	218	204	30-3	4.5	8-Φ25	225
	200	600	375	320	282	260	38-3	4.5	12-Φ30	250
H H41W-64 Y	15	170	105	75	55	40	18-2	4	4-Φ14	110
	20	190	125	90	68	51	20-2	4	4-Φ18	125
	25	210	135	100	78	58	22-2	4	4-Φ18	152
	32	230	150	110	82	66	24-2	4	4-Φ23	168
	40	260	165	125	95	76	24-3	4	4-Φ23	170
	50	300	175	135	105	88	26-3	4	4-Φ23	188
	65	340	200	160	130	110	28-3	4	8-Φ23	205
	80	380	210	170	140	121	30-3	4	8-Φ23	230
	100	430	250	200	168	150	32-3	4.5	8-Φ25	280
	125	500	295	240	202	176	36-3	4.5	8-Φ30	300
	150	550	340	280	240	204	38-3	4.5	8-Φ34	350
	200	650	405	345	300	260	44-3	4.5	12-Φ34	400

# GB Vertical Check Valve

国标立式止回阀 ▶

主要连接尺寸 Main Connection Dimensions

型号 Type	公称通径 DN(mm)	尺寸 Dimension(mm)						
		L	D	D1	D2	b-f	z-Φd	
H H42W-16 Y	15	85	95	65	45	14-2	4-Φ14	
	20	95	105	75	55	14-2	4-Φ14	
	25	105	115	85	65	14-2	4-Φ14	
	32	150	135	100	78	16-2	4-Φ18	
	40	160	145	110	85	16-3	4-Φ18	
	50	170	160	125	100	16-3	4-Φ18	
	65	180	180	145	120	18-3	8-Φ18	
	80	200	195	160	135	20-3	8-Φ18	
	100	210	215	180	155	20-3	8-Φ18	
	125	275	245	210	185	22-3	8-Φ18	
	150	300	280	240	210	24-3	8-Φ23	
	200	380	335	295	265	26-3	12-Φ23	
	250	430	405	355	320	30-3	12-Φ25	
	H H42W-25 Y	15	85	95	65	45	16-2	4-Φ14
		20	95	105	75	55	16-2	4-Φ14
25		105	115	85	65	16-2	4-Φ14	
32		150	135	100	78	18-2	4-Φ18	
40		160	145	110	85	18-3	4-Φ18	
50		170	160	125	100	20-3	4-Φ18	
65		180	180	145	120	22-3	8-Φ18	
80		200	195	160	135	22-3	8-Φ18	
100		210	230	190	160	24-3	8-Φ23	
125		275	270	220	188	28-3	8-Φ25	
150		300	300	250	218	30-3	8-Φ25	
200		380	360	310	278	34-3	12-Φ25	
250		430	425	370	335	36-3	12-Φ30	

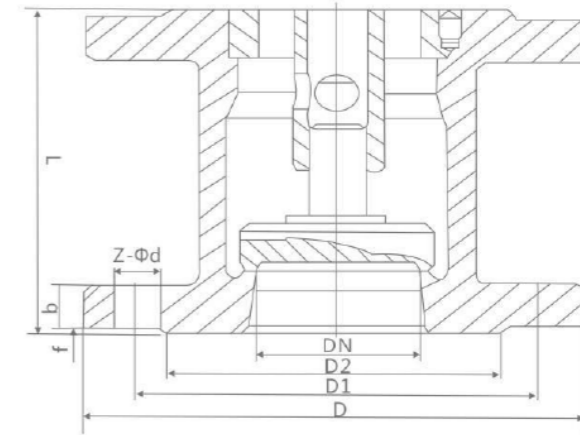



# GB Y Type Filter

国标Y型过滤器 ▶

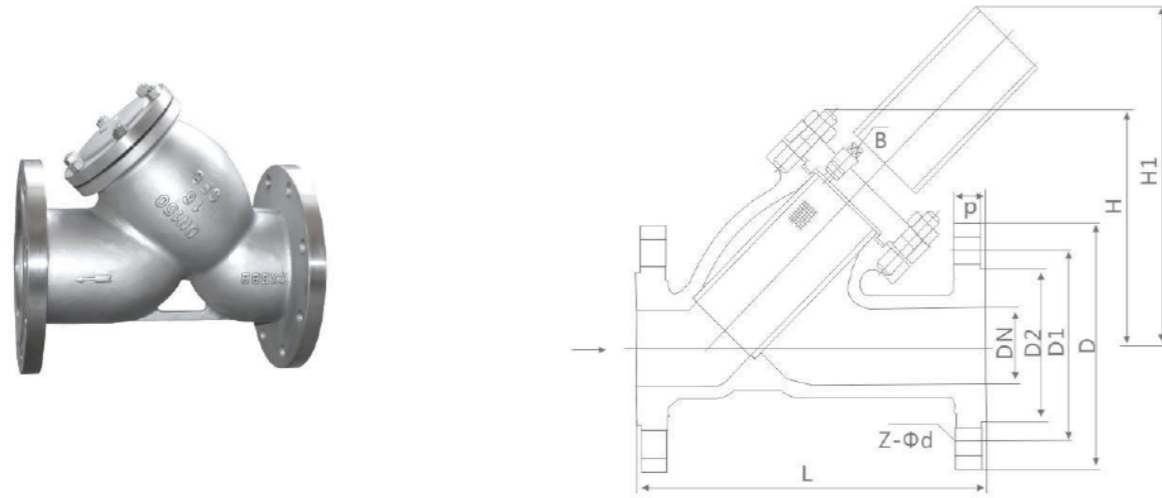

## 产品执行标准 Production enforce standard

产品规范 Product Specification	设计规范 Design Spec	结构长度 Face to Face	连接法兰 Flange End	试验与检验 Test & Check	产品标识 Marking	供货规范 Supply
	GB/T 21637	GB/T 12221	JB/T79	JB/T 9092	GB/T 12220	JB/T 7928

## 主要零件材料 Material for main parts

零件名称 Parts Name	零部件材料 Part Material					
阀体/阀盖 Body/Bonnet	25	WCB	CF8	CF8M	CF3	CF3M
网架 Dis/stem	25	35	1Cr18Ni9Ti	1Cr18Ni12Mo2Ti	00Cr18Ni10	00Cr17Ni14Mo2
滤网 Strainer	1Cr18Ni9Ti		1Cr18Ni9Ti		00Cr18Ni10	
垫片 Gasket	18-8柔性石墨 18-8/Flexible Graphite					
螺栓 Bolt	35		1Cr17Ni2		1Cr18Ni9Ti	
适用温度 Suitable temp	-29~+425°C		-40~+200°C		-40~+200°C	
适用介质 Suitable medium	水、油品、蒸汽 Water, Oil, Steam		硝酸类 Nitric Acid		醋酸类 Acetic Acid	

## 主要连接尺寸 Main Connection Dimensions

公称通径 DN (mm)	15	20	25	32	40	50	65	80	100	125	150	200	250	300	350	400	450	500	600
L	125	150	160	180	200	220	250	280	310	340	390	490	540	590	690	780	850	900	1060
H	60	70	70	75	90	105	150	175	200	205	260	300	380	410	480	540	580	645	780

注：本尺寸表的数据适用于本厂0.25~2.5MPa，压力等级的Y型过滤器。

# Gb three way ball valve

国标三通球阀 ▶

Q44/644/944/45/645/945F-16C/P

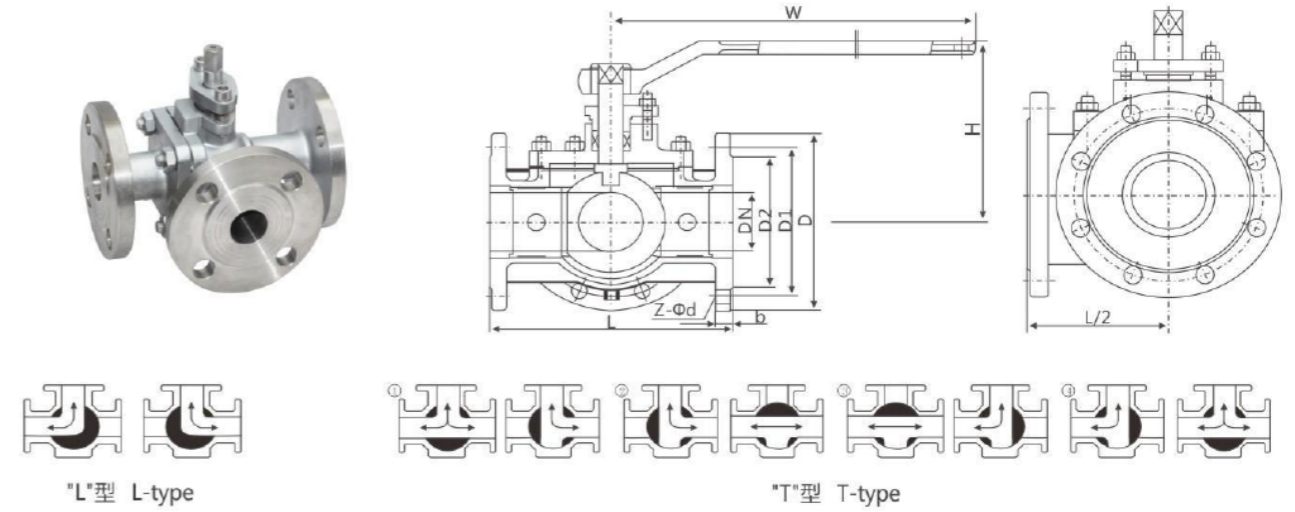

## 主要外形和连接尺寸 Main external and connection dimension

JB/T79.1

公称通径 DN	主要外形尺寸和连接尺寸(mm) Main external and connection dimensions								WT(kg)
	L	D	D1	D2	b	Z-Φd	H	W	
	Q44F-16C Q44F-16P Q644F-16C Q644F-16P Q944F-16C Q944F-16P Q45F-16C Q45F-16P Q645F-16C Q645F-16P Q945F-16C Q945F-16P								
15	150	95	65	45	14	4-Φ14	95	140	4
20	160	105	75	55	14	4-Φ14	105	160	8
25	180	115	85	65	14	4-Φ14	113	180	7
32	200	135	100	78	16	4-Φ18	135	250	12
40	220	145	110	85	16	4-Φ18	142	300	15
50	240	160	125	100	16	4-Φ18	165	350	20
65	260	180	145	120	18	4-Φ18	175	350	25
80	280	195	160	135	20	8-Φ18	190	400	36
100	320	215	180	155	20	8-Φ18	225	500	51
125	380	245	210	185	22	8-Φ18	245	600	77
150	440	280	240	210	24	8-Φ23	265	800	108
200	550	335	295	265	26	12-Φ23	305	800	126
250	670	405	355	320	30	12-Φ25	370	1300	185

# Thin flange ball valve

薄型法兰球阀 ▶

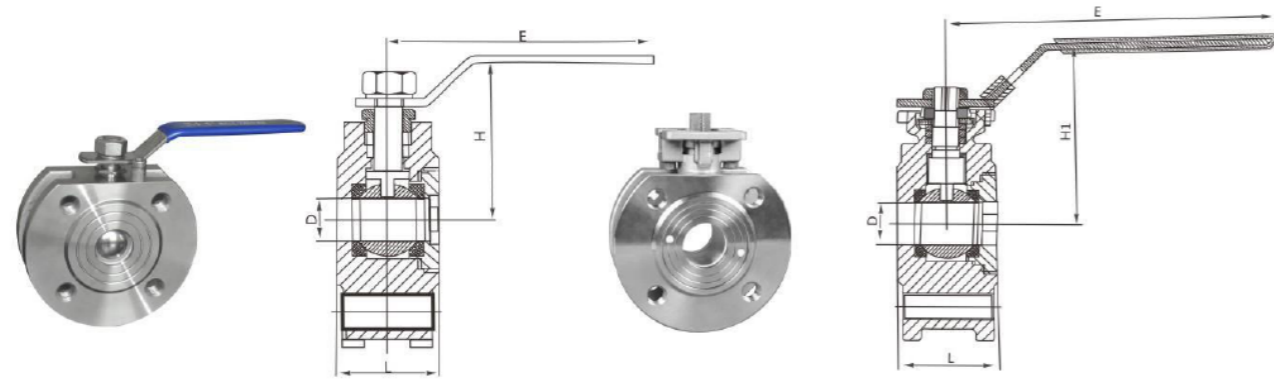

## 主要零部件材料 Main component materials

零件名称	材料		
阀体	WCB	ZG1Gr18 Ni9Ti CF8	ZG1Gr18 Ni12Mo2Ti CF8M
阀盖	WCB	ZG1Gr18 Ni9Ti CF8	ZG1Gr18 Ni12Mo2Ti CF8M
球体	1Cr18Ni9Ti304	1Cr18Ni9Ti304	1Cr18Ni12Mo2Ti 316
阀杆	1Cr18Ni9Ti304	1Cr18Ni9Ti304	1Cr18Ni12Mo2Ti 316
密封圈	聚四氟乙烯 (PTFE)		
填料	聚四氟乙烯 (PTFE)		

## 性能规范

公称压力：PN 1.6, 2.5, 4.0, 6.4, MPa  
 强度试验压力：PT 2.4, 3.8, 6.0, 9.6, MPa  
 低压气密封试验压力：0.6 MPa  
 适用介质：水、油品、气、硝酸类、醋酸类  
 适用温度：-20~180°C

## 主要外形尺寸 Main dimensions

DN	L	D	H	H1	E
15	34	15	70	80	145
20	38	19	77	84	145
25	42	25	75	90	166
32	55	32	88	100	166
40	62	38	100	115	206
50	72	48	108	120	206
65	95	64	115	140	240
80	122	78	135	175	240
100	142	92	145	185	240

# ANSI/ASME Ball Valve

美标球阀 ▶

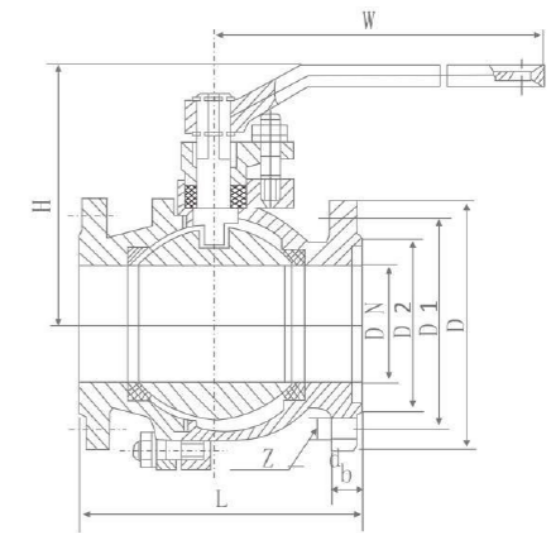

## 标准

设计与制造按BS5351, ANSI B16.34  
 结构长度按ANSI B16.10  
 法兰链接尺寸按ANSI B16.5  
 压力温度额定值按ANSI B16.34  
 检验按API 598

## Standards

Design and manufacture as BS5351, ANSI B16.34  
 Flange to face dimensions as ANSI B16.10  
 End flange dimension as ANSI B16.5  
 Pressure-temperature rating as ANSI B16.34  
 Pressure test as API 598

## 试验压力 Test Pressure

试验项目 Test Item	壳体试验 Shell Test		密封试验 Seal Test		上密封试验 Back Seal Test		气密封试验 Air Seal Test		
介质 Medium	水 Water						气 Air		
单位 Unit	MPa	Ibf/in <sup>2</sup>	MPa	Ibf/in <sup>2</sup>	MPa	Ibf/in <sup>2</sup>	MPa	Ibf/in <sup>2</sup>	
压力等级 (磅级) Pressure (Class)	150	3.1	450	2.2	315	2.2	315	0.5~0.7	60~100
	300	7.8	1125	5.6	815	5.6	815		
	400	10.3	1500	7.6	1100	7.6	1100		
	600	15.3	2225	11.2	1630	11.2	1630		
	900	23.1	3350	16.8	2440	16.8	2440		

## 主要零件材料 Materials for Main Parts

名称 Name	材料 Material								
阀体 Body 阀盖 Bonnet	A216 WCB	A352 LCB	A217 WC6	A217 WC9	A217 C5	A351 CF8	A351 CF8M	A351 CF3	A351 CF3M
球体 Ball	A182 F6	A182 F304					A182 F316	A182 F304L	A182 F316L
阀杆 Stem	A182 F6	A182 F304					A182 F316	A182 F304L	A182 F316L
手柄 Hand Handle	KTH350-10								
螺柱 Bonnet Bolt	A193-B7 A320-L7 A193-B8								
螺母 Nut	A194-2H A194-7 A194-8								



# ANSI/ASME Ball Valve 美标球阀

## 主要连接尺寸 Main Connection Dimensions

型号 Type	型号规格 Size(mm)		尺寸 Dimension(mm)							
	Inch	DN	L	D	D1	D2	b	z-Φd	H	W
Q41H-150Lb Q341H-150Lb Q641H-150Lb	1/2"	15	108	89	60.5	35	12	4-Φ15	68	115
	3/4"	20	117	98	70	43	12	4-Φ15	75	130
	1"	25	127	108	79.5	51	12	4-Φ15	85	150
	1 1/4"	32	140	117	89	64	13	4-Φ15	96	190
	1 1/2"	40	165	127	98.5	73.2	15	4-Φ15	107	230
	2"	50	178	152	120.7	92	16	4-Φ19	118	240
	2 1/2"	65	190	177.8	139.7	104.7	18	4-Φ19	145	280
	3"	80	203	190.5	152.5	127	19	4-Φ19	160	310
	4"	100	229	229	190.5	157	24	8-Φ19	185	330
	5"	125	356	254	216	185.7	26	8-Φ22	230	600
Q41H-300Lb Q341H-300Lb Q641H-300Lb	1/2"	15	140	95	66.5	35	15	4-Φ15	72	115
	3/4"	20	152	117	82.5	43	16	4-Φ19	75	130
	1"	25	165	124	89	51	18	4-Φ19	85	150
	1 1/4"	32	178	133	98.5	64	19.5	4-Φ19	95	180
	1 1/2"	40	190	156	114.3	73.2	21	4-Φ22	110	230
	2"	50	216	165	127	92	23	8-Φ19	120	240
	2 1/2"	65	241	190.5	149.4	104.7	26	8-Φ22	120	280
	3"	80	283	210	168.2	127	29	8-Φ22	150	310
	4"	100	305	254	200.2	157	32	8-Φ22	165	330
	5"	125	381	279	235	185.7	35	8-Φ22	190	600
Q41H-600Lb Q341H-600Lb Q641H-600Lb	1/2"	15	165	95	66.5	35	15	4-Φ15	88	115
	3/4"	20	190	118	82.5	43	16	4-Φ19	98	130
	1"	25	216	124	89	51	18	4-Φ19	105	150
	1 1/2"	40	241	156	114.3	73.2	23	4-Φ22	135	180
	2"	50	292	165	127	92	26	8-Φ19	155	240
	3"	80	356	210	168.2	127	32	8-Φ22	175	280
	4"	100	432	273	216	157	38	8-Φ25	210	330
	6"	150	559	356	292	216	48	12-Φ29	340	800
	8"	200	660	419	349	270	56	12-Φ32	400	1000
	10"	250	787	508	432	324	64	16-Φ35	440	1200

# ANSI/ASME Gate Valve 美标闸阀

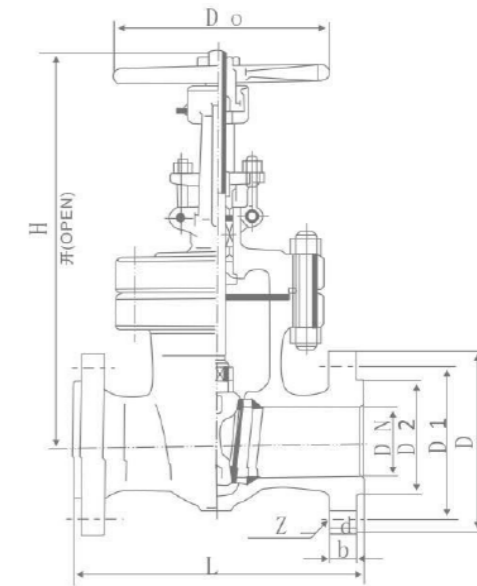

## 标准

设计与制造按API600, ANSI B16.34  
结构长度按ANSI B16.10  
法兰连接尺寸按ANSI B16.5  
压力温度额定值按ANSI B16.34  
检验按API 598

## Standards

Design and manufacture as API600, ANSI B16.34  
Face to face dimensions as ANSI B16.10  
End flange dimension as ANSI B16.5  
Pressure-temperature rating as ANSI B16.34  
Pressure test as API 598

## 试验压力 Test Pressure

试验项目 Test Item	壳体试验 Shell Test		密封试验 Seal Test		上密封试验 Back Seal Test		气密封试验 Air Seal Test		
介质 Medium	水 Water						气 Air		
单位 Unit	MPa	Ibf/in <sup>2</sup>	MPa	Ibf/in <sup>2</sup>	MPa	Ibf/in <sup>2</sup>	MPa	Ibf/in <sup>2</sup>	
压力等级 (磅级) Pressure (Class)	150	3.1	450	2.2	315	2.2	315	0.5~0.7	60~100
	300	7.8	1125	5.6	815	5.6	815		
	400	10.3	1500	7.6	1100	7.6	1100		
	600	15.3	2225	11.2	1630	11.2	1630		
	900	23.1	3350	16.8	2440	16.8	2440		
	1500	38.4	5575	28.1	4080	28.1	4080		

## 主要零件材料 Materials for Main Parts

名称 Name	材料 Material									
阀体 Body 阀盖 Bonnet 闸板 Wedge	A216 WCB	A352 LCB	A217 WC6	A217 WC9	A217 C5	A351 CF8	A351 CF8M	A351 CF3	A351 CF3M	
阀杆 Stem	A182 F6	A182 F304					A182 F316	A182 F304L	A182 F316L	
阀杆螺母 Stem Nut	ZcuAl10Fe3 Bronze									
手轮 Handwheel	KTH350-10									
螺柱 Bonnet Bolt	A193-B7 A320-L7 A193-B8									
螺母 Nut	A194-2H A194-7 A194-8									

# ANSI/ASME Gate Valve 美标闸阀

## 主要连接尺寸 Main Connection Dimensions

型号 Type	型号规格 Size(mm)		尺寸 Dimension(mm)								
	Inch	DN	L	D	D <sub>1</sub>	D <sub>2</sub>	b	z-Φd	H	D <sub>0</sub>	
H Z40W-150Lb Y	1/2"	15	108	89	60.5	35	12	4-Φ15	180	120	
	3/4"	20	117	98	70	43	12	4-Φ15	185	120	
	1"	25	127	108	79.5	51	12	4-Φ15	225	140	
	1 1/4"	32	140	117	89	64	13	4-Φ15	245	160	
	1 1/2"	40	165	127	98.6	73.2	15	4-Φ15	310	180	
	2"	50	178	152	120.7	92	16	4-Φ19	335	200	
	2 1/2"	65	190	177.8	139.7	104.7	18	4-Φ19	350	220	
	3"	80	203	190.5	152.4	127	19	4-Φ19	420	240	
	4"	100	229	229	190.5	157	24	8-Φ19	485	280	
	5"	125	254	254	216	185.7	26	8-Φ22	515	300	
	6"	150	267	279	241.3	216	26	8-Φ22	565	320	
	8"	200	292	343	298.5	270	29	8-Φ22	760	400	
	H Z540W-150Lb Y	10"	250	330	406	362	324	31	12-Φ25	950	450
		12"	300	356	483	432	381	21	12-Φ25	1075	500
		14"	350	381	533	476.3	413	35	12-Φ29	1160	500
		16"	400	406	597	540	470	37	16-Φ29	1345	550
H Z940W-150Lb Y	18"	450	432	635	578	533.4	40	16-Φ32	1450	550	
	20"	500	457	698.5	635	584	43	20-Φ32	1600	600	
	24"	600	508	813	749.3	692	48	20-Φ35	1720	650	
	26"	650	559	870	806	749.5	69	24-Φ35	1820	650	
	28"	700	610	927	863	800	72	28-Φ35	2000	700	
	30"	750	610	984	914.4	857	75	28-Φ35	2200	700	
	32"	800	660	1060.5	978	914.4	81	28-Φ42	2400	750	
	36"	900	711	1168	1086	1022.4	91	32-Φ42	2600	800	
	H Z40W-300Lb Y	1/2"	15	140	95	66.5	35	15	4-Φ15	190	120
		3/4"	20	152	117	82.5	43	16	4-Φ19	200	120
		1"	25	165	124	89	51	18	4-Φ19	225	140
		1 1/4"	32	178	133	98.5	64	19	4-Φ19	255	160
		1 1/2"	40	190	156	114.3	73	21	4-Φ22	320	180
		2"	50	216	165	127	92	23	8-Φ19	360	220
		2 1/2"	65	241	190.5	149.4	104.7	26	8-Φ22	400	240
		3"	80	283	210	168.2	127	29	8-Φ22	455	280
4"		100	305	254	200.2	157	32	8-Φ22	500	300	
5"		125	381	279	235	185.7	35	8-Φ22	555	320	
H Z540W-300Lb Y		6"	150	403	318	270	216	37	12-Φ22	650	350
		8"	200	419	381	330	270	42	12-Φ25	900	450
		10"	250	459	445	387.5	324	48	16-Φ29	970	500
		12"	300	502	521	451	381	51	16-Φ32	1110	550
H Z940W-300Lb Y		14"	350	762	584	514.5	413	54	20-Φ32	1220	600
		16"	400	838	648	571.5	470	58	20-Φ35	1430	650
	18"	450	914	711	628.7	533.4	61	24-Φ35	1510	700	
	20"	500	991	775	685.8	584	64	24-Φ35	1680	750	
	24"	600	1143	914.4	812.8	692	70	24-Φ41	1820	800	
	26"	650	1245	972	876	749.5	80	24-Φ45	1920	850	
	28"	700	1345	1035	939.8	800	86	28-Φ45	2100	900	
	H Z40W-600Lb Y	1/2"	15	165	95	66.5	35	15	4-Φ15	190	120
		3/4"	20	190	118	82.5	43	16	4-Φ19	200	120
		1"	25	216	124	89	51	18	4-Φ19	230	140
		1 1/4"	32	229	133	98.5	64	21	4-Φ19	260	160
		1 1/2"	40	241	156	114.5	73.2	23	4-Φ22	330	180
		2"	50	292	165	127	92	26	8-Φ19	380	250
		2 1/2"	65	330	190.5	149.4	104.7	29	8-Φ22	420	300
		3"	80	356	210	168.2	127	32	8-Φ22	470	300
		4"	100	432	273	216	157	38	8-Φ25	570	350
H Z540W-600Lb Y		5"	125	508	330	266.7	185.7	45	8-Φ29	650	450
		6"	150	559	356	292	216	48	12-Φ29	700	450
		8"	200	660	419	349	270	56	12-Φ32	880	500
		10"	250	787	508	432	324	64	16-Φ35	1020	600
H Z940W-600Lb Y		12"	300	838	559	489	381	67	20-Φ35	1230	700
		14"	350	889	603	527	413	70	20-Φ38	1300	750
		16"	400	991	686	603	470	77	20-Φ41	1450	800
	18"	450	1092	743	654	533.4	83	20-Φ44	1550	850	
	20"	500	1194	813	724	584	89	24-Φ44	1720	900	
	24"	600	1397	940	838	692	102	24-Φ52	1860	950	

# ANSI/ASME Globe Valve 美标截止阀

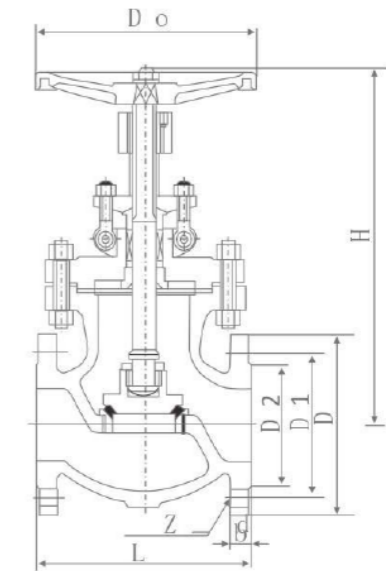

## 标准

设计与制造按BS1873, ANSI B16.34  
结构长度按ANSI B16.10  
法兰链接尺寸按ANSI B16.5  
压力温度额定值按ANSI B16.34  
检验按API 598

## Standards

Design and manufacture as BS1873, ANSI B16.34  
Face to face dimensions as ANSI B16.10  
End flange dimension as ANSI B16.5  
Pressure-temperature ratings as ANSI B16.34  
Pressure test as API 598

## 试验压力 Test Pressure

试验项目 Test Item	壳体试验 Shell Test		密封试验 Seal Test		上密封试验 Back Seal Test		气密封试验 Air Seal Test		
介质 Medium	水 Water						气 Air		
单位 Unit	MPa	Ibf/in <sup>2</sup>	MPa	Ibf/in <sup>2</sup>	MPa	Ibf/in <sup>2</sup>	MPa	Ibf/in <sup>2</sup>	
压力等级 (磅级) Pressure (Class)	150	3.1	450	2.2	315	2.2	315	0.5~0.7	60~100
	300	7.8	1125	5.6	815	5.6	815		
	400	10.3	1500	7.6	1100	7.6	1100		
	600	15.3	2225	11.2	1630	11.2	1630		
	900	23.1	3350	16.8	2440	16.8	2440		

## 主要零件材料 Materials for Main Parts

名称 Name	材料 Material									
阀体 Body 阀盖 Bonnet 阀瓣 Wedge	A216 WCB	A352 LCB	A217 WC6	A217 WC9	A217 C5	A351 CF8	A351 CF8M	A351 CF3	A351 CF3M	
阀杆 Stem	A182 F6	A182 F304					A182 F316	A182 F304L	A182 F316L	
阀杆螺母 Stem Nut	ZcuAl10Fe3 Bronze									
手轮 Handwheel	KTH350-10									
螺柱 Bonnet Bolt	A193-B7 A320-L7 A193-B8									
螺母 Nut	A194-2H A194-7 A194-8									



# ANSI/ASME Globe Valve 美标截止阀

主要连接尺寸 Main Connection Dimensions

型号 Type	型号规格 Size(mm)		尺寸 Dimension(mm)							
	inch	DN	L	D	D1	D2	b	z-Φd	H	D0
H J41W-150Lb Y	1/2"	15	108	89	60.5	35	12	4-Φ15	200	100
	3/4"	20	117	98	70	43	12	4-Φ15	205	120
	1"	25	127	108	79.5	51	12	4-Φ15	230	140
	1 1/4"	32	140	117	89	64	13	4-Φ15	240	140
	1 1/2"	40	165	127	98.5	73.2	15	4-Φ16	270	160
	2"	50	203	152	120.7	92	16	4-Φ19	300	200
H J541W-150Lb Y	2 1/2"	65	216	177.8	139.7	104.7	18	4-Φ19	340	220
	3"	80	241	190.5	152.5	127	19	4-Φ19	360	240
	4"	100	292	229	190.5	157	24	8-Φ19	420	280
	5"	125	356	254	216	185.7	26	8-Φ22	460	350
H J941W-150Lb Y	6"	150	406	279	241.3	216	26	8-Φ22	500	400
	8"	200	495	343	298.5	270	29	8-Φ22	590	450
	10"	250	622	406	362	324	31	12-Φ25	710	500
	12"	300	698	483	432	381	32	12-Φ25	810	550
	14"	350	787	533	476.3	413	35	12-Φ29	880	600
	16"	400	914	597	540	470	37	16-Φ29	940	650
H J41W-300Lb Y	1/2"	15	152	95	66.5	35	15	4-Φ15	220	120
	3/4"	20	178	117	82.5	43	16	4-Φ19	230	120
	1"	25	203	124	89	51	18	4-Φ19	260	140
	1 1/4"	32	216	133	98.5	64	19	4-Φ19	280	140
	1 1/2"	40	229	156	114.3	73.2	21	4-Φ22	300	200
	2"	50	267	165	127	92	22	8-Φ19	330	240
H J541W-300Lb Y	2 1/2"	65	292	190.5	149.4	104.7	25	8-Φ22	360	240
	3"	80	318	210	168.2	127	29	8-Φ22	400	280
	4"	100	356	254	200.2	157	32	8-Φ22	450	320
	5"	125	400	279	235	185.7	35	8-Φ22	500	400
H J941W-300Lb Y	6"	150	444	318	270	216	37	12-Φ22	540	450
	8"	200	559	381	330	270	41	12-Φ25	670	500
	10"	250	622	445	387.5	324	48	16-Φ29	770	550
	12"	300	711	521	451	381	51	16-Φ32	855	600
	14"	350	762	584	514.5	413	54	20-Φ32	920	650
	16"	400	864	648	571	470	58	20-Φ35	970	700
H J41W-600Lb Y	1/2"	15	165	95	66.5	35	15	4-Φ15	220	120
	3/4"	20	190	118	82.5	43	16	4-Φ19	230	120
	1"	25	216	124	89	51	18	4-Φ19	260	140
	1 1/4"	32	229	133	98.5	64	21	4-Φ19	280	140
	1 1/2"	40	241	156	114.3	73	23	4-Φ22	300	200
	2"	50	292	165	127	92	26	8-Φ19	360	280
H J541W-600Lb Y	2 1/2"	65	330	190.5	149.4	104.7	29	8-Φ22	400	300
	3"	80	356	210	168.2	127	32	8-Φ22	440	350
	4"	100	432	273	216	157	38	8-Φ25	500	400
	5"	125	508	330	266.7	185.7	45	8-Φ29	600	450
H J941W-600Lb Y	6"	150	559	356	292	216	48	12-Φ29	720	500
	8"	200	660	419	349	270	56	12-Φ32	800	550
	10"	250	787	508	432	324	64	16-Φ35	870	600
	12"	300	838	559	489	381	67	20-Φ35	940	750
	1 1/2"	40	305	179	123.8	92	32	4-Φ29	350	280
	2"	50	368	216	165.1	92	38.5	8-Φ26	420	300
H J541W-900Lb Y	2 1/2"	65	419	244	190.5	104.7	41.5	8-Φ29	450	350
	3"	80	381	241	190.5	127	38.5	8-Φ26	470	400
	4"	100	457	292	234.9	157	44.5	8-Φ32	550	450
	5"	125	595	349	279.4	185.7	51.0	8-Φ35	650	500
H J941W-900Lb Y	6"	150	610	381	317.5	216	56.0	12-Φ32	750	550
	8"	200	737	470	393.7	270	63.5	12-Φ39	850	600
	10"	250	838	545	459.9	324	70.0	16-Φ39	1000	750

# ANSI/ASME Swing Check Valve 美标旋启式止回阀

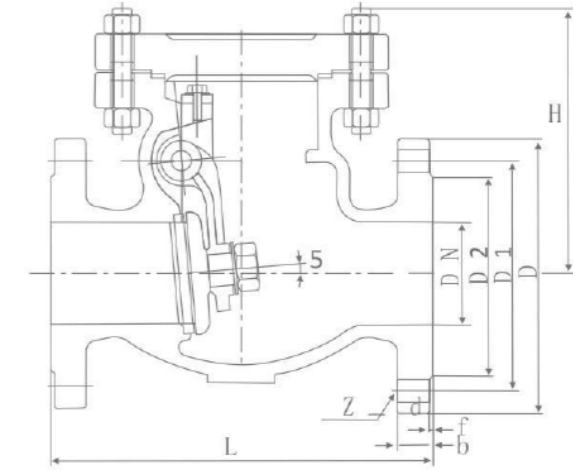

## 标准

设计与制造按BS1868, ANSI B16.34  
结构长度按ANSI B16.10  
法兰链接尺寸按ANSI B16.5  
压力温度额定值按ANSI B16.34  
检验按API 598

## Standards

Design and manufacture as BS1868, ANSI B16.34  
Face to face dimensions as ANSI B16.10  
End flange dimension as ANSI B16.5  
Pressure-temperature rating as ANSI B16.34  
Pressure test as API 598

## 试验压力 Test Pressure

试验项目 Test Item	壳体试验 Shell Test		密封试验 Seal Test		上密封试验 Back Seal Test		气密封试验 Air Seal Test		
介质 Medium	水 Water						气 Air		
单位 Unit	MPa	Ibf/in <sup>2</sup>	MPa	Ibf/in <sup>2</sup>	MPa	Ibf/in <sup>2</sup>	MPa	Ibf/in <sup>2</sup>	
压力等级 (磅级) Pressure (Class)	150	3.1	450	2.2	315	2.2	315	0.5~0.7	60~100
	300	7.8	1125	5.6	815	5.6	815		
	400	10.3	1500	7.6	1100	7.6	1100		
	600	15.3	2225	11.2	1630	11.2	1630		
	900	23.1	3350	16.8	2440	16.8	2440		
	1500	38.4	5575	28.1	4080	28.1	4080		

## 主要零件材料 Materials for Main Parts

名称 Name	材料 Material									
阀体 Body	A216 WCB	A352 LCB	A217 WC6	A217 WC9	A217 C5	A351 CF8	A351 CF8M	A351 CF3	A351 CF3M	
阀盖 Bonnet										
阀瓣 Wedge										
摇杆 Arm										
支架 Yoke										
销轴 Arm Pin	A182 F6	A182 F304					A182 F316	A182 F304L	A182 F316L	
螺栓 Bonnet Bolt	A193-B7 A320-L7 A193-B8									
螺母 Nut	A194-2H A194-7 A194-8									

# ANSI/ASME Swing Check Valve

美标旋启式止回阀 ▶

主要连接尺寸 Main Connection Dimensions

型号 Type	型号规格 Size(mm)		尺寸 Dimension(mm)							
	Inch	DN	L	D	D1	D2	b	Z-Φd	H	
H H44W-150Lb Y	1"	25	127	108	79.5	51	12	4-Φ15	90	
	1½"	40	165	127	98.5	73	15	4-Φ15	115	
	2"	50	203	152	120.7	92	16	4-Φ19	150	
	2½"	65	216	177.8	139.7	104.7	18	4-Φ19	160	
	3"	80	241	190.5	152.4	127	19	4-Φ19	180	
	4"	100	292	229	190.5	157	24	8-Φ19	220	
	5"	125	330	254	216	185.7	26	8-Φ22	280	
	6"	150	356	279	241.3	216	26	8-Φ22	340	
	8"	200	495	343	298.5	270	29	8-Φ22	400	
	10"	250	622	406	362	324	31	12-Φ25	460	
	12"	300	698	483	432	381	32	12-Φ25	530	
	14"	350	787	533	476.3	413	35	12-Φ29	580	
	16"	400	864	597	540	470	37	16-Φ29	600	
	18"	450	978	635	578	533.4	40	16-Φ32	650	
	20"	500	978	698.5	635	584	43	20-Φ32	700	
	24"	600	1295	813	749.3	692	48	20-Φ35	780	
28"	700	1448	927	863.6	800	72	28-Φ35	850		
30"	800	1524	984	914.4	857	75	28-Φ35	920		
H H44W-300Lb Y	2"	50	267	165	127	92	23	8-Φ19	170	
	2½"	65	292	190.5	149.4	104.7	26	8-Φ22	180	
	3"	80	318	210	168.2	127	29	8-Φ22	210	
	4"	100	356	254	200.2	157	32	8-Φ22	290	
	5"	125	400	279	235	185.7	35	8-Φ22	290	
	6"	150	444	318	270	216	37	12-Φ22	350	
	8"	200	533	381	330	270	42	12-Φ25	430	
	10"	250	622	445	387.5	324	48	16-Φ29	480	
	12"	300	711	521	451	381	51	16-Φ32	550	
	14"	350	838	584	514.5	413	54	20-Φ32	620	
	16"	400	864	648	571.5	470	58	20-Φ35	650	
	18"	450	978	711	628.7	533.4	61	24-Φ35	690	
	20"	500	1016	775	685.8	584	64	24-Φ35	740	
	24"	600	1346	914.4	812.8	692	70	24-Φ41	800	
	28"	700	1499	1035	939.8	800	86	28-Φ45	860	
	30"	800	1594	1092	997	857	92	28-Φ48	980	
H H44W-600Lb Y	2"	50	292	165	127	92	26	8-Φ19	190	
	2½"	65	330	190.5	149.4	104.7	29	8-Φ22	210	
	3"	80	356	210	168.2	127	32	8-Φ22	230	
	4"	100	432	273	216	157	38	8-Φ25	300	
	5"	125	508	330	266.7	185.7	45	8-Φ29	310	
	6"	150	559	356	292	216	48	12-Φ29	370	
	8"	200	660	419	349	270	56	12-Φ32	450	
	10"	250	787	508	432	324	64	16-Φ35	500	
	12"	300	838	559	489	381	67	20-Φ35	570	
	14"	350	889	603	527	413	70	20-Φ38	640	
	16"	400	991	686	603	470	77	20-Φ41	670	
	18"	450	1092	743	654	533.4	83	20-Φ44	710	
	20"	500	1194	855	724	584	89	24-Φ44	760	
	24"	600	1397	1040	838	692	102	24-Φ52	830	
	H H44W-900Lb Y	2"	50	368	216	165.1	92	38.5	8-Φ26	220
		2½"	65	419	244	190.5	104.7	41.5	8-Φ29	250
3"		80	381	241	190.5	127	38.5	8-Φ26	270	
4"		100	457	292	234.9	157	44.5	8-Φ32	330	
5"		125	559	349	279.4	185.7	51	8-Φ35	350	
6"		150	610	384	317.5	216	56	12-Φ32	420	
8"		200	737	470	393.7	270	63.5	12-Φ39	490	
10"		250	838	545	469.9	324	70	16-Φ39	550	
12"		300	965	610	533.4	381	79.5	20-Φ39	630	
14"		350	1029	640	558.8	413	86	20-Φ42	680	
16"		400	1130	705	615.9	470	89	20-Φ45	720	
18"		450	1219	785	685.8	533.4	102	20-Φ51	750	
20"		500	1321	855	749.3	584	108	20-Φ54	800	
24"		600	1549	1040	901.7	692	140	20-Φ67	880	

# Japanese Standard Ball Valve

日标球阀 ▶

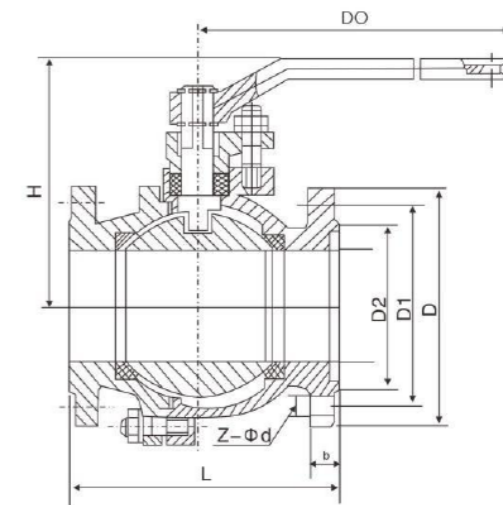

执行标准 Administer Standard

设计与制造 Design and Manufacture	结构长度 Face to Face	法兰尺寸 Flange Dimension	压力-温度 Pressure Temperature Rating	试验-检验 Inspection and Test
BS 5351	JIS B2002	JIS B2212 B2214	JIS B2201	JIS B2003

规格主要尺寸 Size Main Dimensions

DN		10K							
mm	in	L	D	D1	D2	B	Z-Φd	H	D0
15	½"	108	95	70	52	12	4-Φ15	59	130
20	¾"	117	100	75	58	14	4-Φ15	63	130
25	1"	127	125	90	70	14	4-Φ19	75	160
32	1¼"	140	135	100	80	16	4-Φ19	75	160
40	1½"	165	140	105	85	16	4-Φ19	95	230
50	2"	178	155	120	100	16	4-Φ19	107	230
65	2½"	190	175	140	120	18	4-Φ19	142	400
80	3"	203	185	150	130	18	8-Φ19	152	400
100	4"	229	210	175	155	18	8-Φ19	178	700
125	5"	356	250	210	185	20	8-Φ23	252	1100
150	6"	394	280	240	215	22	8-Φ23	272	1100
200	8"	457	330	290	265	22	12-Φ23	342	1500
		20K							
15	½"	140	95	70	52	14	4-Φ15	59	130
20	¾"	152	100	75	58	16	4-Φ15	63	130
25	1"	165	125	90	70	16	4-Φ19	75	160
32	1¼"	178	135	100	80	18	4-Φ19	75	160
40	1½"	190.5	140	105	85	18	4-Φ19	95	230
50	2"	216	155	120	100	18	8-Φ19	107	230
65	2½"	241	175	140	120	20	8-Φ19	142	400
80	3"	283	200	160	135	22	8-Φ22	152	400
100	4"	305	225	185	160	24	8-Φ22	178	700
125	5"	381	270	225	195	26	8-Φ22	252	1100
150	6"	403	305	260	230	28	12-Φ22	272	1100
200	8"	502	350	305	275	30	12-Φ25	342	1500



**jis gate Valve**  
日标闸阀 ▶

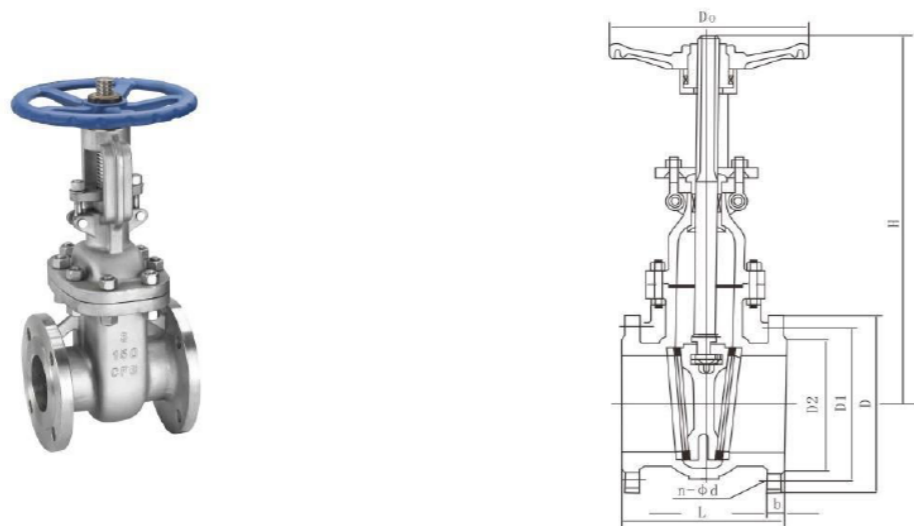

**执行标准 Execution standard**

设计与制造 Design and Manufacture	结构长度 Face to Face	法兰尺寸 Flange Dimension	压力-温度 Pressure Temperature Rating	试验-检验 Inspection and Test
JIS B2073 B2083	JIS B2002	JIS B2212 B2214	JIS B2073 B2083	JIS B2003

**规格主要尺寸 Size Main Dimensions**

DN		10K		
mm	in	L	H	D0
50	2	178	409	200
65	2½	190	535	250
80	3	203	570	250
100	4	229	590	250
150	6	267	630	300
200	8	292	960	350
250	10	330	1158	400
300	12	356	1378	450
350	14	381	1543	500
400	16	406	1738	600
450	18	432	1959	600
500	20	457	2214	680
20K				
50	2	216	480	200
65	2½	241	510	250
80	3	283	580	280
100	4	305	700	350
150	6	403	940	400
200	8	419	1190	450
250	10	457	1390	500
300	12	502	1600	500
350	14	762	1750	600
400	16	838	1900	600
450	18	914	2320	650

**Day mark globe valve**  
日标截止阀 ▶

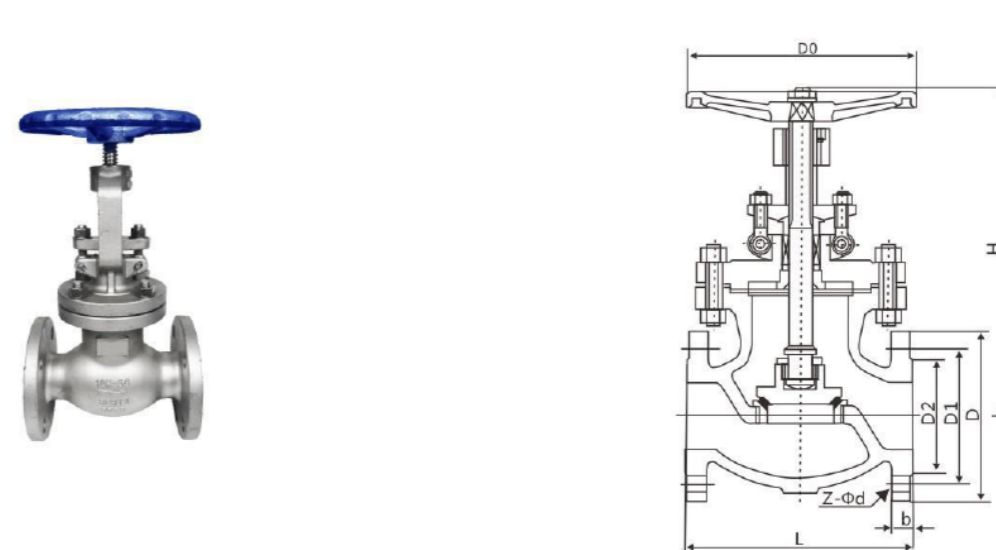

**执行标准 Execution standard**

设计与制造	结构长度	法兰尺寸	压力-温度	试验-检验
JIS B2071 B2081	JIS B2002	JIS B2212 B2214	JIS B2071 B2081	JIS B2003

**性能规范 The performance specification**

阀体材料	SCPH2-11	SCPH-32	SCS13A	SCS19A	SCS 14A	SCS16A	SCPL1
适用温度	≤425°C	≤540°C	≤275°C	≤200°C	≤275°C	≤200°C	-45~-150°C
适用介质	水蒸气 油品		硝酸类		醋酸类		氨气 液氨

**规格主要尺寸 Main size**

DN		10K							
mm	Im	L	D	D1	D2	b	n-φd	H	D0
50	2	203	155	120	100	16	4-φ19	360	200
65	2½	216	175	140	120	18	4-φ19	380	200
80	3	241	185	150	130	18	8-φ19	415	250
100	4	292	210	175	155	18	8-φ19	465	250
125	5	356	250	210	185	20	8-φ23	515	300
150	6	406	280	240	215	22	8-φ23	545	350
200	8	495	330	290	265	22	12-φ23	675	450
		20K							
50	2	267	155	120	100	18	8-φ19	420	200
65	2½	292	175	140	120	20	8-φ19	465	250
80	3	318	200	160	135	22	8-φ23	490	300
100	4	356	225	185	160	24	8-φ23	590	350
125	5	400	270	225	195	26	8-φ25	690	400
150	6	444	305	260	230	28	12-φ25	760	450
200	8	559	350	305	275	30	12-φ25	1070	450

## D343H worm gear flange type metal hard seal butterfly valve

### D343H蜗轮传动法兰式金属硬密封蝶阀

D343<sup>H</sup><sub>F</sub>-10C.P.R连接尺寸

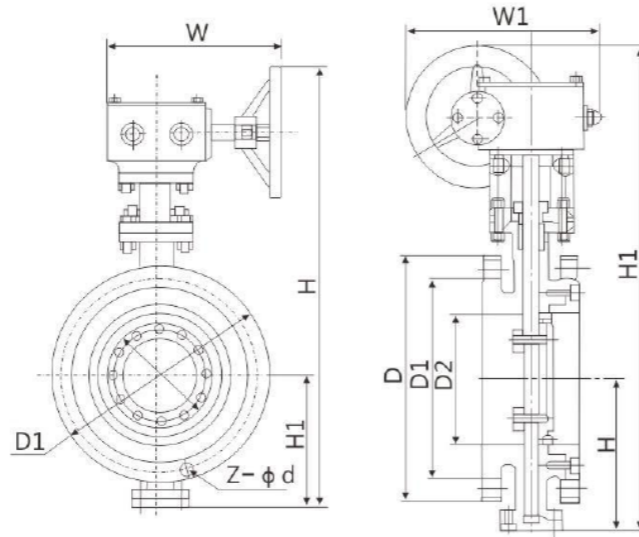

#### 应用规范

设计、制造按GB/T12238-1989  
 结构长度按GB/T12221-2005  
 连接法兰：GB/T9113-2000  
 阀门检查和试验按JB/T9092-1999

#### Application specification

Design, manufacture : GB/T12238-1989  
 Length of the structure : GB/T12221-2005  
 Connecting flange : GB/T9113-2000  
 Valve inspection and test : JB/T9092-1999

通径DN	L	D	D1	D2	Z-φd	b	H	H1	W	W1	D0
50	108	165	125	99	4-18	20	360	112	200	200	160
65	112	185	145	118	4-18	20	380	115	200	200	160
80	114	200	160	132	8-18	20	455	120	220	200	160
100	127	220	180	156	8-18	22	490	140	240	200	160
125	140	250	210	184	8-18	22	490	170	260	200	160
150	140	285	240	211	8-22	24	630	180	280	280	240
200	152	340	295	266	8-22	24	690	210	320	280	240
250	165	395	350	319	12-22	26	830	240	360	280	240
300	178	445	400	370	12-22	26	930	290	460	420	310
350	190	505	460	429	16-22	26	1010	320	500	420	310
400	216	565	515	480	16-26	26	1070	350	540	420	310
450	222	615	565	530	20-26	28	1140	380	580	420	310
500	229	670	620	582	20-26	28	1200	410	620	420	310
600	267	780	725	682	20-30	34	1340	470	660	420	310
700	292	895	840	794	24-30	34	1600	550	750	550	400
800	318	1015	950	901	24-33	36	1780	640	800	550	400
900	330	1115	1050	1001	28-33	38	1920	710	850	550	400
1000	410	1230	1160	1112	28-36	38	1960	770	1000	750	500
1200	470	1455	1380	1328	32-39	44	2360	875	1050	750	500
1400	530	1675	1590	1530	36-42	48	2530	970	800	890	600
1600	600	1915	1820	1750	40-48	52	2640	1100	800	890	600
1800	670	2115	2020	1950	44-48	56	2800	1200	830	920	700
2000	760	2325	2230	2150	48-48	60	3100	1290	850	940	700

## D343H worm gear flange type metal hard seal butterfly valve

### D343H蜗轮传动法兰式金属硬密封蝶阀

D343<sup>H</sup><sub>F</sub>-16C.P.R连接尺寸

通径DN	L	D	D1	D2	Z-φd	b	H	H1	W	W1	D0
50	108	165	125	99	4-18	20	360	112	200	200	160
65	112	185	145	118	4-18	20	380	115	200	200	160
80	114	200	160	132	8-18	20	455	120	220	200	160
100	127	220	180	156	8-18	22	490	140	240	200	160
125	140	250	210	184	8-18	22	490	170	260	200	160
150	140	285	240	211	8-22	24	630	180	280	280	240
200	152	340	295	266	12-22	24	690	210	320	280	240
250	165	405	355	319	12-26	26	830	240	360	280	240
300	178	460	410	370	12-26	28	930	290	460	420	310
350	190	520	470	429	16-26	30	1010	320	500	420	310
400	216	580	525	480	16-30	32	1070	350	540	420	310
450	222	640	585	548	20-30	40	1140	380	580	420	310
500	229	715	650	609	20-33	44	1200	410	620	420	310
600	267	840	770	720	20-36	44	1340	470	660	420	310
700	292	910	840	794	24-36	50	1600	550	750	550	400
800	318	1025	950	901	24-39	52	1780	640	800	550	400
900	330	1125	1050	1001	28-39	54	1920	710	850	550	400
1000	410	1255	1170	1112	28-42	56	1960	770	1000	750	500
1200	470	1485	1390	1328	32-48	44	2360	875	1050	750	500
1400	530	1690	1590	1530	36-48	48	2530	970	800	890	600
1600	600	1930	1820	1750	40-56	52	2640	1100	800	890	600

D343<sup>H</sup><sub>F</sub>-25C.P.R连接尺寸

通径DN	L	D	D1	D2	Z-φd	b	H	H1	W	W1	D0
50	108	165	125	99	4-18	20	360	112	200	200	160
65	112	185	145	118	8-18	22	380	115	200	200	160
80	114	200	160	132	8-18	24	455	120	220	200	160
100	127	235	190	156	8-22	24	490	140	240	200	160
125	140	270	220	184	8-26	26	490	170	260	200	160
150	140	300	250	211	8-26	28	630	180	280	280	240
200	152	360	310	274	12-26	30	690	210	320	280	240
250	165	425	370	330	12-30	32	830	240	360	280	240
300	178	485	430	389	16-30	34	930	290	460	420	310
350	190	555	490	448	16-33	38	1010	320	500	420	310
400	216	620	550	503	16-36	40	1070	350	540	420	310
450	222	670	600	548	20-36	46	1140	380	580	420	310
500	229	730	660	609	20-36	48	1200	410	620	420	310
600	267	845	770	720	20-39	58	1340	470	660	420	310
700	292	960	875	820	24-42	50	1600	550	750	550	400
800	318	1085	990	928	24-48	54	1780	640	800	550	400
900	330	1185	1090	1028	28-48	58	1920	710	850	550	400
1000	410	1320	1210	1140	28-55	62	1960	770	1000	750	500

D343<sup>H</sup><sub>F</sub>-40C.P.R连接尺寸

通径DN	L	D	D1	D2	D6	Z-φd	b	H	H1	W	W1	D0
50	150	165	125	99	88	4-18	20	360	112	200	200	160
65	170	185	145	118	110	8-18	22	380	115	200	200	160
80	180	200	160	132	121	8-18	24	455	120	220	200	160
100	190	235	190	156	150	8-22	24	490	140	240	200	160
125	200	270	220	184	176	8-26	26	490	170	260	200	160
150	210	300	250	211	204	8-26	28	630	180	280	280	240
200	230	375	320	284	260	12-30	34	690	210	320	280	240
250	250	450	385	345	313	12-33	38	830	240	360	280	240
300	270	515	450	409	364	16-33	42	930	290	460	420	310
350	290	580	510	465	422	16-36	46	1010	320	500	420	310
400	310	660	585	535	474	16-39	50	1070	350	540	420	310



## D373H worm gear pair of clip type metal hard seal butterfly valve

D373H蜗轮传动对夹式金属硬密封蝶阀 ▶

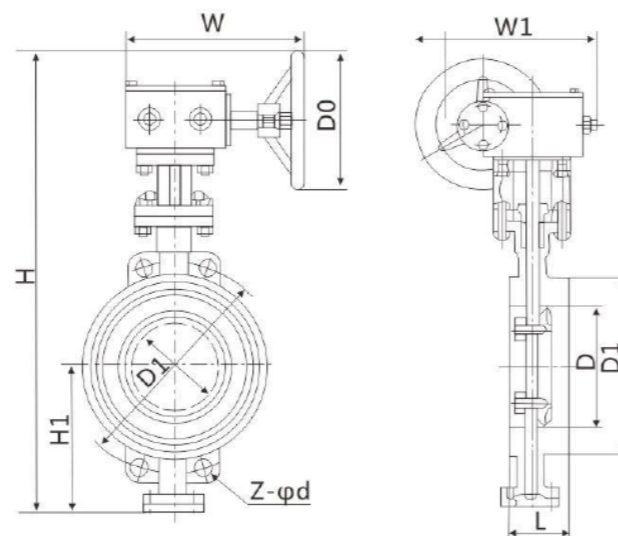

### 应用规范

设计、制造按GB/T12238-1989

结构长度按GB/T12221-2005

连接法兰：GB/T9113-2000

阀门检查和试验按JB/T9092-1999

### Application specification

Design, manufacture : GB/T12238-1989

Length of the structure : GB/T12221-2005

Connecting flange : GB/T9113-2000

Valve inspection and test : JB/T9092-1999

### D373<sup>H</sup><sub>F</sub>-10C.P.R连接尺寸

通径DN	L	D1	D	Z-φd	H	H1	W	W1	D0
50	43	125	102	4-18	360	112	200	200	160
65	46	145	122	4-18	380	115	200	200	160
80	49	160	133	8-18	455	120	220	200	160
100	56	180	158	8-18	490	140	240	200	160
125	64	210	184	8-18	490	170	260	200	160
150	70	240	212	8-22	630	180	280	280	240
200	71	295	268	8-22	690	210	320	280	240
250	76	350	320	12-22	830	240	360	280	240
300	83	400	370	12-22	930	290	460	420	310
350	92	460	430	16-22	1010	320	500	420	310
400	102	515	482	16-26	1070	350	540	420	310
450	114	565	532	20-26	1140	380	580	420	310
500	127	620	585	20-26	1200	410	620	420	310
600	154	725	685	20-30	1340	470	660	420	310
700	165	840	800	24-30	1600	550	750	550	400
800	190	950	905	24-33	1780	640	800	550	400
900	203	1050	1005	28-33	1920	710	850	550	400
1000	216	1160	1110	28-36	1960	770	1000	750	500
1200	254	1380	1330	32-39	2360	875	1050	750	500
1400	279	1590	1530	36-42	2530	970	800	890	-
1600	318	1820	1750	40-48	2640	1100	800	890	-
1800	356	2020	1950	44-48	2800	1200	830	920	-
2000	406	2230	2150	48-48	3100	1290	850	940	-

## D373H worm gear pair of clip type metal hard seal butterfly valve

D373H蜗轮传动对夹式金属硬密封蝶阀 ▶

### D373<sup>H</sup><sub>F</sub>-16C.P.R连接尺寸

通径DN	L	D1	D	Z-φd	H	H1	W	W1	D0
50	43	125	102	4-18	360	112	200	200	160
65	46	145	122	4-18	380	115	200	200	160
80	49	160	133	8-18	455	120	220	200	160
100	56	180	158	8-18	490	140	240	200	160
125	64	210	184	8-18	490	170	260	200	160
150	70	240	212	8-22	630	180	280	280	240
200	71	295	268	12-22	690	210	320	280	240
250	76	355	320	12-26	830	240	360	280	240
300	83	410	370	12-26	930	290	460	420	310
350	92	470	430	16-26	1010	320	500	420	310
400	102	525	482	16-30	1070	350	540	420	310
450	114	585	532	20-30	1140	380	580	420	310
500	127	650	585	20-33	1200	410	620	420	310
600	154	770	685	20-36	1340	470	660	420	310
700	165	840	800	24-36	1600	550	750	550	400
800	190	950	905	24-39	1780	640	800	550	400
900	203	1050	1005	28-39	1920	710	850	550	400
1000	216	1170	1110	28-42	1960	770	1000	750	500
1200	254	1390	1330	32-48	2360	875	1050	750	500
1400	279	1590	1530	36-48	2530	970	800	890	-
1600	318	1820	1750	40-56	2640	1100	800	890	-

### D373<sup>H</sup><sub>F</sub>-25C.P.R连接尺寸

通径DN	L	D1	D	Z-φd	H	H1	W	W1	D0
50	43	125	102	4-18	360	112	200	200	160
65	46	145	122	8-18	380	115	200	200	160
80	49	160	133	8-18	455	120	220	200	160
100	56	190	158	8-22	490	140	240	200	160
125	64	220	184	8-26	490	170	260	200	160
150	70	250	212	8-26	630	180	280	280	240
200	71	310	268	12-26	690	210	320	280	240
250	76	370	330	12-30	830	240	360	280	240
300	83	430	390	16-30	930	290	460	420	310
350	92	490	450	16-33	1010	320	500	420	310
400	102	550	505	16-36	1070	350	540	420	310
450	114	600	555	20-36	1140	380	580	420	310
500	127	660	610	20-36	1200	410	620	420	310
600	154	770	720	20-39	1340	470	660	420	310
700	165	875	820	24-42	1600	550	750	550	400
800	190	990	930	24-48	1780	640	800	550	400
900	203	1090	1030	28-48	1920	710	850	550	400
1000	216	1210	1140	28-56	1960	770	1000	750	500

### D373<sup>H</sup><sub>F</sub>-40C.P.R连接尺寸

通径DN	L	D1	D	Z-φd	H	H1	W	W1	D0
50	43	125	102	4-18	360	112	200	200	160
65	46	145	122	8-18	380	115	200	200	160
80	49	160	133	8-18	455	120	220	200	160
100	56	190	158	8-22	490	140	280	200	160
125	64	220	184	8-26	490	170	280	200	160
150	76	250	212	8-26	630	180	280	280	240
200	89	320	268	12-30	690	210	280	280	240
250	114	385	330	12-33	825	240	280	280	240
300	114	450	390	16-33	908	290	450	420	310
350	127	510	450	16-36	960	320	450	420	310
400	140	585	505	16-39	1330	350	540	437	310

## Threaded ball valve

丝扣球阀 ▶

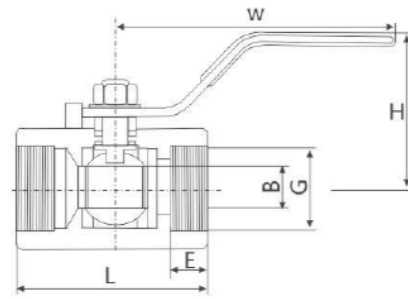

1PC Ball valve  
一片式球阀

DN	G	B	L	E	H	W
10	3/8"	6	45	13	36	70
15	1/2"	9	55	16	39	80
20	3/4"	12	60	18	43	90
25	1"	15	70	20	46	105
32	1 1/2"	20	80	21.5	53	120
40	1 1/4"	25	86	23	59	130
50	2"	32	101	24.5	65	145

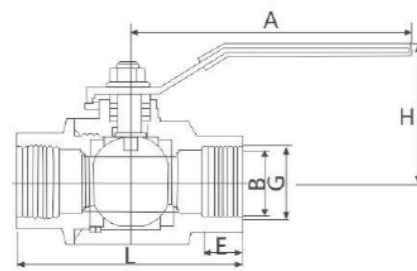

2PC Ball valve  
二片式球阀

DN	G	B	L	E	H	A
6	1/4"	10	55	11.5	50	95
10	3/8"	12	55	11.5	50	95
15	1/2"	15	57	14	55	105
20	3/4"	20	65	15	65	120
25	1"	25	79	15	72	140
32	1 1/4"	32	90	18	80	155
40	1 1/2"	38	98	19	95	170
50	2"	50	116	19	105	185
65	2 1/2"	65	148	23	120	220

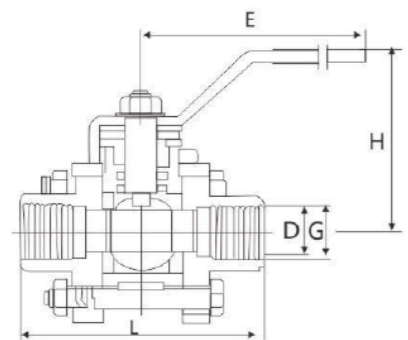

3PC Ball valve  
三片式球阀

DN	G	D	L	H	E
6	1/4"	10	65	50	95
10	3/8"	12	65	50	95
15	1/2"	15	75	55	105
20	3/4"	20	80	60	120
32	1 1/4"	32	110	82	155
40	1 1/2"	38	120	90	170
50	2"	50	140	105	220
65	2 1/2"	64	160	120	245
80	3"	78	180	132	270
100	4"	100	215	160	315

## Threaded valve

丝扣阀门 ▶

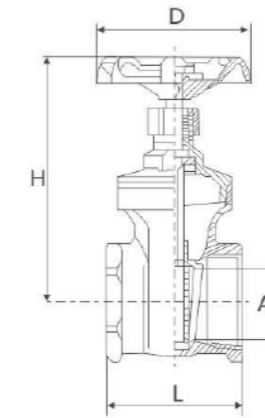

Z15W Gate valve  
Z15W闸阀

SIZE	1/2"	3/4"	1"	1 1/4"	1 1/2"	2"
A	15	20	25	32	38	50
H	90	98	108	128	152	166
L	55	60	68	76	80	93
D	70	70	80	80	100	100

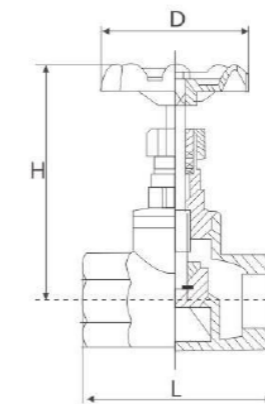

J11W Globe valve  
J11W截止阀

DN	15	20	25	32	40	50
SIZE	1/2"	3/4"	1"	1 1/4"	1 1/2"	2"
L	65	75	90	105	120	140
H	88	95	110	123	135	150
D	70	70	80	100	100	100

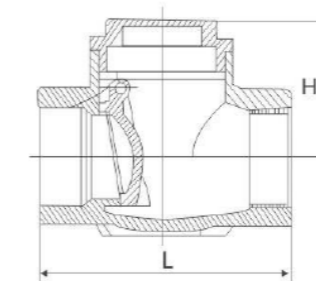

H14W Check valve  
H14W止回阀

DN	15	20	25	32	40	50
SIZE	1/2"	3/4"	1"	1 1/4"	1 1/2"	2"
L	65	75	90	105	120	140
H	42	46	54	58	66	74





## 售后服务和质量保证承诺

随着国家市场经济的深入发展，市场竞争日趋激烈，广大用户对产品的要求也越来越高，并且对售后服务方面的要求也越来越多。为此，我公司质量管理部门为适应市场发展的要求，专门设立了售后服务组、配备了专职服务人员负责处理我公司的产品售后服务事宜。同时我公司坐在内部质量管理方面也作出了多方努力，为此我公司完全可以做到：

一、产品配发检验合格证书和说明书，以确保用户能正确安装使用我公司产品。

二、我公司保证出厂的产品均按有关国际标准生产和检验，不合格产品绝不出厂。保证严格履行、兑现产品的四包，严格执行国家工业产品售后服务有关规定，对出厂产品自发货日起的十八个月内，在产品说明书规定的正常操作条件下我公司将负责质保期内质量完好。

三、如用户对我公司产品提出的质量异议，公司保证在接到用户提出异议后2小时内作出处理意见。若需要现场解决的，保证派出专业技术服务人员，并做到质量问题不解决服务人员不撤离。对每件用户反馈的产品质量文艺及处理结果我公司将存档。

以上三点是我公司对售后服务的承诺。竭诚欢迎广大用户批评指正，请提出宝贵意见，参照改进。真诚希望我们之间合作愉快。



## After-sales service and quality assurance commitment

With the in-depth development of the national market economy, the market competition is becoming increasingly fierce, the majority of users have higher and higher requirements on products, and more and more requirements on after-sales service. Therefore, in order to meet the requirements of market development, the quality management department of our company has set up a special after-sales service group and equipped with full-time service personnel to handle the after-sales service of our company's products. At the same time, our company has made multiple efforts in internal quality management, for which our company is fully capable of:

I. the product shall be issued with inspection certificate and instruction manual to ensure that the user can correctly install and use the product of our company.

II. Our company guarantees that the products are produced and inspected in accordance with relevant international standards, and the unqualified products will never leave the factory. Guarantee to strictly perform and fulfill the four packages of products, strictly implement the relevant provisions of the national industrial product after-sales service, and within 18 months from the date of spontaneous delivery of the products, our company will be responsible for the quality of the products within the warranty period under the normal operating conditions specified in the product manual.

3. In case of any quality objection raised by the user, the company shall guarantee that it will make disposal Suggestions within 2 hours upon receipt of such objection. If on-site solution is needed, professional and technical service personnel shall be dispatched, and service personnel shall not be evacuated until quality problems are solved. We will archive the quality literature and processing results of each piece of feedback from users.

The above three points are our company's commitment to after-sales service. Sincerely welcome the majority of users to criticize and testify, please put forward valuable opinions, reference to improve. We sincerely hope that we can cooperate happily.